



5 Onslow Court, Barton On Sea, BH25 7FB

£239,950

Mitchells
1963 — TODAY



*5 Onslow Court
Atkinson Close
Barton On Sea
New Milton
Hampshire
BH25 7FB*

A stunning penthouse apartment in this small and prestigious block of just five properties constructed by highly regarded local developers Pennyfarthing and are immaculately presented throughout. The property is set over two floors and particular features include a superb modern kitchen, a security entry system, allocated parking, a lovely double aspect bedroom with built in wardrobe, an impressive triple aspect kitchen/dining room benefitting from a sunny aspect and an internal viewing is strongly recommended to fully appreciate the quality of the property.

- Entrance Hall
- Stairway
- Landing
- Sitting/Dining Room
- Kitchen
- Double Bedroom
- Bathroom
- Allocated Parking
- Communal Gardens



The Property

Communal hallway with security entry system and stairs to the first floor.

Entrance hall with attractive staircase to second floor landing with a double glazed Velux window, trap to private roof space and a double storage cupboard housing a wall mounted glow worm gas fired boiler.

Impressive triple aspect sitting/dining room with attractive timber effect flooring and a sunny aspect.

Modern kitchen fitted with a range of wall and base units with a contrasting marble effect worktop and an inset one and a half bowl sink unit with mixer tap over, attractive wall tiling, timber effect flooring, integrated Neff electric oven, four burner gas hob and extractor, integrated fridge and separate freezer, slimline dishwasher and space for washing machine.

Double bedroom benefitting from a double aspect and one double and one single built in wardrobe.

Bathroom fitted with a white suite comprising a panel bath with a mixer tap and shower attachment over, wash basin with storage beneath, WC, part tiled walls, timber effect flooring, extractor fan and double glazed Velux window.





Gardens & Grounds

The property sits its own well maintained communal grounds and gardens, the upkeep of which is paid for out of the annual maintenance.

The property also benefits from an allocated parking space in addition to the visitor parking.

Services

- Mains gas, electric, drainage and water
- Council Tax Band B
- Energy Performance Rating C

Second Floor

Approx. 56.7 sq. metres (610.8 sq. feet)

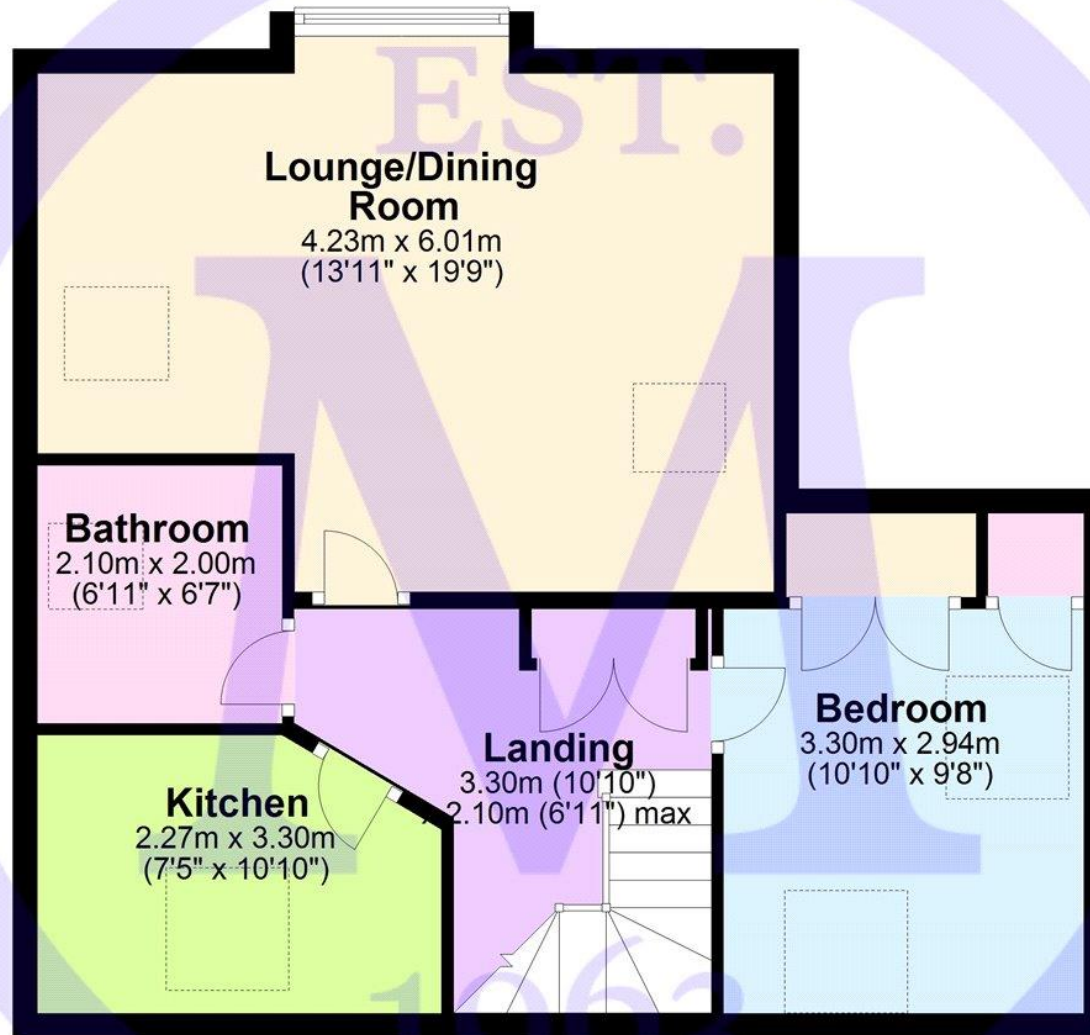

'Whilst every attempt has been made to ensure the accuracy of this floor plan, the measurements of doors, windows, rooms and any other items are approximate and no responsibility is taken for any error, omission or mis-statement. This plan is for illustrative purposes only and should be used as such by any prospective purchaser.'

Plan produced using PlanUp.

5 Onslow Court, Barton on sea

Situation

Barton on Sea is a suburb of New Milton and occupies an enviable position on a picturesque stretch of the Solent coastline with stunning views over Christchurch bay to the Isle of Wight and beautiful coastal walks in both directions. Fuelled by its excellent location, the nearby open forest of the New Forest National Park, main line rail links to London Waterloo, quality schooling, luxury restaurants including the renowned Chewton Glen hotel and Pebble Beach on the cliff top, a links style 27 hole golf course, Barton on Sea is an extremely popular choice for those relocating to the coast.

Directions

From Mitchells turn right at the traffic lights and proceed along Station Road. At the roundabout turn right onto Lymington Road. Take the second turning left into Becton Lane. Take the second right into Highlands Road. Bare left and turn right Atkinson Close where Onslow Court will be seen towards the end on the left hand side.

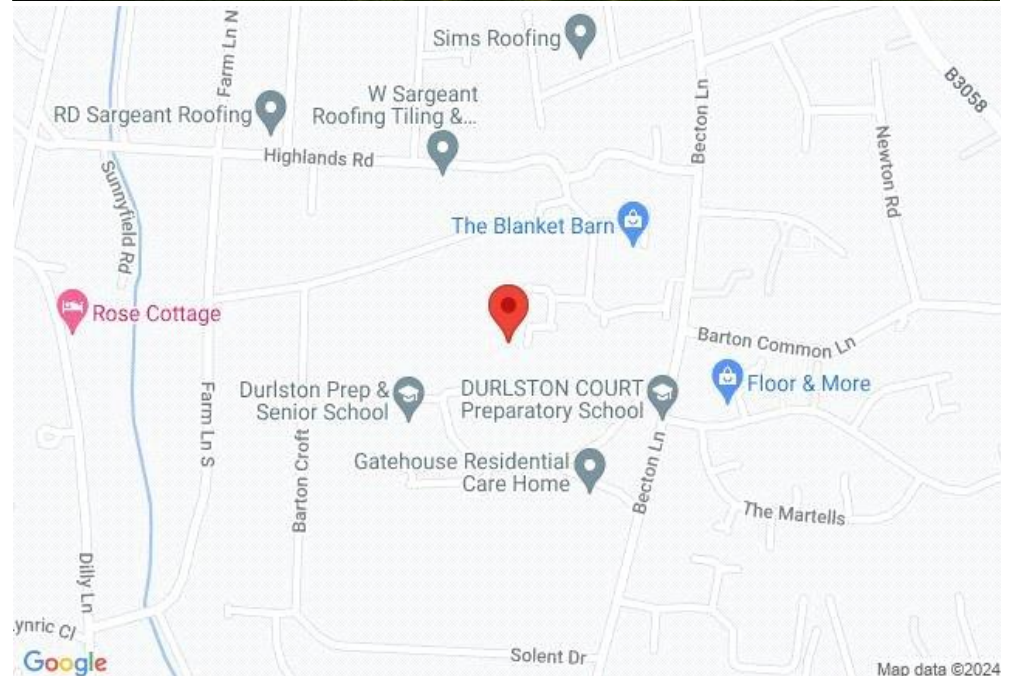



Mitchells.uk.com
info@mitchells.uk.com
01425 616411

Centenary Buildings
8-10 Old Milton Road
New Milton
Hampshire
BH25 6DT

Mitchells
1963 — TODAY

