



Jumpers Road, Christchurch, Dorset BH23 2JT

Mitchells
1963 — TODAY



Jumpers Road, Christchurch, Dorset BH23 2JT

A characterful and well-presented detached house of nearly 1200 sq ft situated in this popular area within Twynham School catchment. This lovely home benefits from driveway parking at the front and a private, mature garden to the rear with various outbuildings and storage sheds. Jumpers Road is on the outskirts of the town centre with all the superb amenities that this area has to offer being right on your doorstep. The mainline train station of Christchurch is a short walk away and the house also falls in to the catchment area of the popular local schools.

THREE BEDROOMS • FAMILY BATHROOM • KITCHEN • LOUNGE • DINING ROOM • ORANGERY

UTILITY ROOM • GARDEN • GARDEN ROOM

DRIVEWAY PARKING FOR SEVERAL CARS



The Property

- Immaculate detached house of about 1155 sq ft
- Spacious master bedroom with built in wardrobes
- Two further bedrooms with a full family bathroom
- Kitchen with separate utility room and downstairs w/c
- Good size living room with character features
- Dining room and orangery extension leading onto the garden
- Driveway with parking for several cars
- Lovely garden with patio, lawn and garden shed
- Garden building with power
- Council Tax Band 'D' - £2,217.98
- EPC rating 'D'





Location

Christchurch is a beautiful, vibrant and historic town with its 11th century priory, quay/harbour, ancient castle ruins and various shops, cafes, restaurants and bars. The Town is well served for transport links with a main line railway station to London/Waterloo being just under 2 hours and Bournemouth International Airport about 5 miles distant. Excellent infant, junior and senior schools are also within easy reach as is the stunning the New Forest National Park.

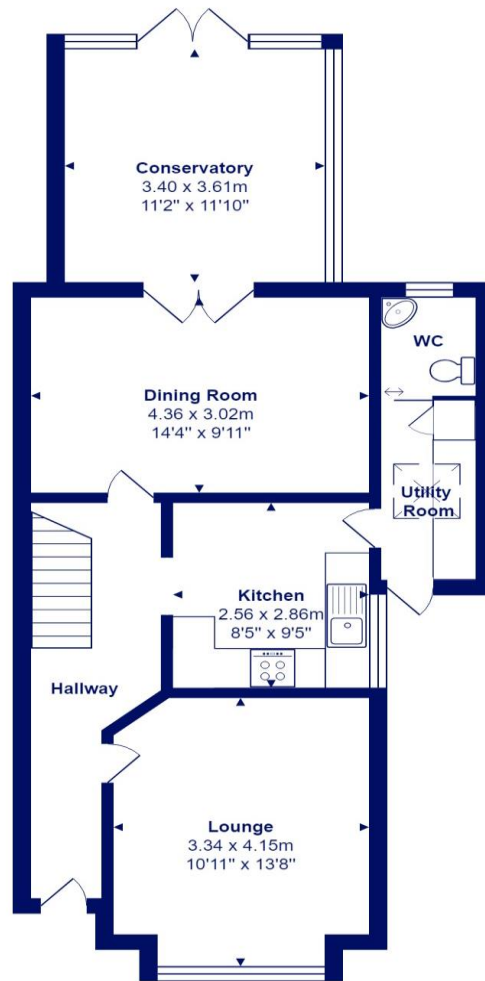

Ground Floor

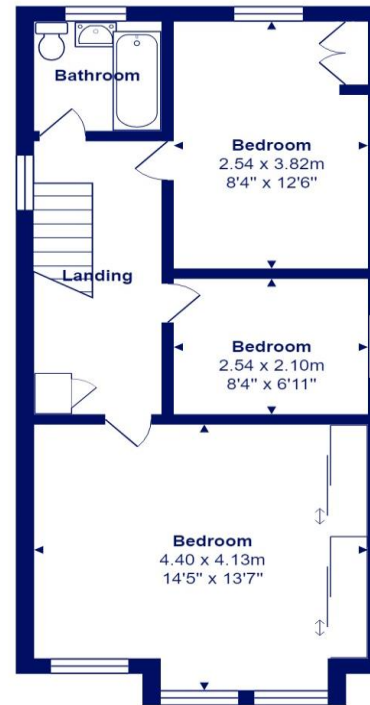

First Floor



Total Area: 107.3 m² ... 1155 ft²

All measurements are approximate and for display purposes only







mitchells.uk.com
mudford@mitchells.uk.com
01202 499295

Mudford
Cambridge House
112-114 Stanpit
BH23 3ND

