



HALIFAX WAY, MUDEFORD, CHRISTCHURCH BH23 4TX

Mitchells
1963 — TODAY



HALIFAX WAY, MUDEFORD, CHRISTCHURCH BH23 4TX

A very well presented end-terrace house situated on this popular development within the catchment area of the local schools and within walking distance of the beach at Friars Cliff. This lovely home features fantastic open plan living space which has been extended creating a modern kitchen with access to the garden, spacious lounge/diner and ground floor wet room. The first floor features three bedrooms and a family bathroom and there is a sunny garden to the rear and casual parking to the front. No forward chain.

THREE BEDROOMS • FAMILY BATH/SHOWER ROOM • GROUND FLOOR WET ROOM

KITCHEN • LOUNGE/DINING ROOM

GARDEN • CASUAL PARKING



The Property

- End-terrace property of approx. 790 sq.ft
- Three Bedrooms
- First floor family bathroom and ground floor wet room
- Good size sitting /dining room
- Ground floor extension featuring a modern kitchen
- Sunny rear garden with storage shed
- Casual car parking nearby
- Gas fired central heating and UPVC double glazed windows
- Council Tax Band 'C' - £1971.54
- EPC Rating 'C'





Location

Mudford began as a small fishing village close to the entrance of Christchurch Harbour which still sees fishing boats landing their catch today. The area enjoys award winning sandy beaches at Avon beach and plenty of wildlife activity on Hengistbury Head and Stanpit Marsh Nature Reserve. The popular Mudford Sandbank attracts visitors every year to the private beach huts with the Harbour providing a sheltered environment for water sports activities. With a friendly, community feel, it is no wonder Mudford is becoming a popular choice for relocation.

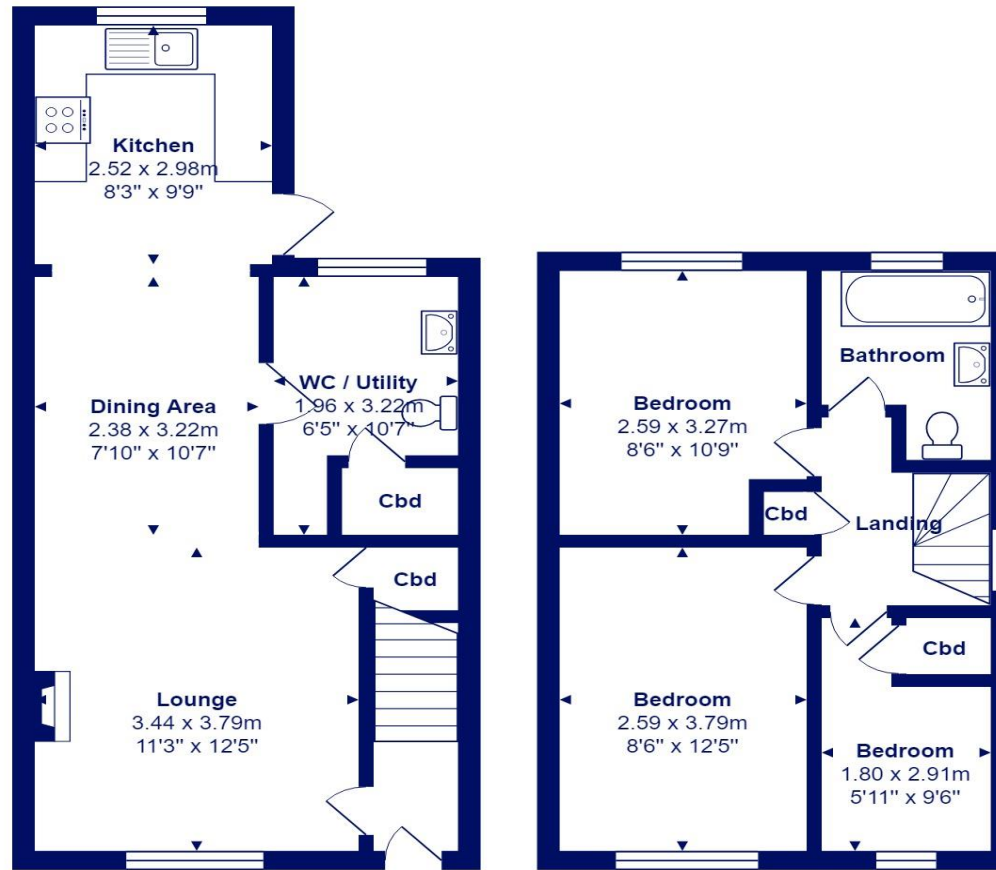

Ground Floor

First Floor



Total Area: 73.3 m² ... 789 ft²

All measurements are approximate and for display purposes only







mitchells.uk.com

mundeford@mitchells.uk.com

01202 499295

Mundeford

Cambridge House

112-114 Stanpit

BH23 3ND

