



*159 Sycamore, Bashley Caravan Park, BH25 5QR*

*£59,995*

**Mitchells**  
1963 — TODAY





*159 Sycamore  
Bashley Caravan Park  
Sway Road  
New Milton  
BH25 5QR*

This lovely holiday home is situated just behind the golf course at Bashley Park and is a short walk of all amenities. The property is offered with vacant possession and has been beautifully maintained with features including a luxury kitchen/dining room, a master bedroom with ensuite and a private raised decking.

- Kitchen/Dining Room
- Sitting Room
- Hallway
- Two Bedrooms
- Shower Room
- Ensuite Shower Room
- Decking
- 40 x 12.6





## The Property

Entrance hall with useful coat hooks, cupboard housing the central heating boiler and double radiator.

This opens through to the kitchen/dining room which has a bright double aspect, a lovely range of timber effect wall and base units with a contrasting worktop, integrated appliances include a microwave, cooker with double oven, under counter fridge and freezer and slimline dishwasher. There is a four seater table and chairs and two UPVC windows.

This opens through to the sitting room with an L shaped sofa, separate armchair, pull out sofa bed and double casement doors leading onto the decking.

The main shower room is beautifully fitted out with walk in double shower with sliding glass shower doors and thermostatic shower attachment, wash hand basin with mixer tap over and storage beneath, WC and heated towel rail.

Bedroom two is a twin with two single beds and built in wardrobes.

The master bedroom is situated at the rear of the property with a built in double bed, bedside cabinets, beautifully built in furniture and an ensuite shower room.

The ensuite shower room comprises of a corner WC, wash hand basin with mixer tap over, walk in double shower with thermostatic shower attachments and sliding glass shower doors.





## *Gardens & Grounds*

To the front of the property is a bright south facing decking making a fantastic area for outside dining.



## *Services*

- Mains gas, electric, drainage and water



## Ground Floor

Approx. 45.2 sq. metres (486.6 sq. feet)

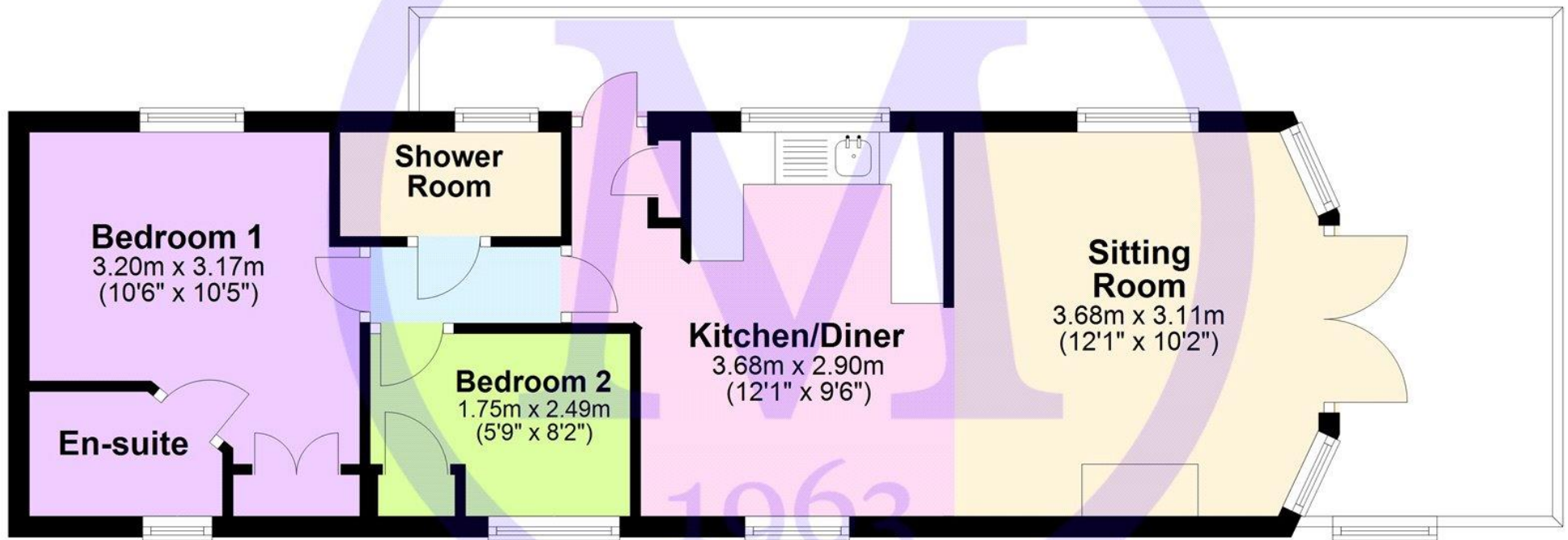

Total area: approx. 45.2 sq. metres (486.6 sq. feet)

'Whilst every attempt has been made to ensure the accuracy of this floor plan, the measurements of doors, windows, rooms and any other items are approximate and no responsibility is taken for any error, omission or mis-statement. This plan is for illustrative purposes only and should be used as such by any prospective purchaser.'

Plan produced using PlanUp.



## Situation

In the heart of the enchanting New Forest Hoburne Bashley is a magical place to escape to with the open forest of the New Forest National Park, Barton on Sea clifftop and beach and New Milton high street all within easy reach. Facilities on offer at the park include an impressive entertainment complex, 9 hole golf course, heated pools, café and Brasserie, convenience store and a multi-use games area.

## Directions

From Mitchells turn left at the traffic lights and proceed over the railway bridge. Upon reaching the roundabout turn right onto Sway Road. After 500 yards turn left into Hoburne Bashley, follow the road round past the reception building and follow the signs for Sycamore.



### Park map

- 1 Reception & entertainment complex
- 2 The Venue
- 3 Café h
- 4 Beauty h
- 5 Brasserie 1932
- 6 Lounge bar
- 7 Indoor pool
- 8 Outdoor pool
- 9 Adventure playground
- 10 Crazy golf
- 11 Multi-use sports court
- 12 Holiday home sales office
- 13 Laundrette
- 14 Park shop
- 15 Woodland h
- 16 Toddler's play area
- 17 Outdoor café
- 18 Archery tunnel
- 19 Woodland Activity Area
- 20 Accessible Woodland Walks, Fairy Trail and Picnic Areas
- 21 Recycling
- 22 Nature trail







[Mitchells.uk.com](http://Mitchells.uk.com)  
[info@mitchells.uk.com](mailto:info@mitchells.uk.com)  
01425 616411

Centenary Buildings  
8-10 Old Milton Road  
New Milton  
Hampshire  
BH25 6DT

**Mitchells**  
1963 — TODAY

