



*7 Foxcote Gardens, New Milton, BH25 5XD*

*£375,000*

**Mitchells**  
1963 — TODAY



*7 Foxcote Gardens  
New Milton  
Hampshire  
BH25 5XD*

This fantastic three bedroom detached house is located on a popular development within walking distance of New Milton town centre and local schools. The property offers bright and modern accommodation, with features including a refitted kitchen and bathroom, two attractive reception rooms, a sunny southwest facing garden, a driveway, and a garage.

- Entrance Hall
- Cloakroom
- Sitting Room
- Dining Room
- Kitchen
- First Floor Landing
- Three Bedrooms
- Family Bathroom
- Driveway
- Garage
- Sunny & Secluded Southwest Facing Garden



## The Property

Entrance hall with timber effect flooring, an understairs storage cupboard, central heating controls, and a double radiator.

Ground floor cloakroom with a white suite comprising a WC, wash hand basin with mixer tap and storage beneath, tiled splashback, a UPVC window, and a radiator.

The kitchen is fitted with a modern range of shaker style base units, a timber effect worktop, tiled splashback, a wall mounted Worcester combination boiler, electrical consumer unit, and a stainless steel sink with mixer tap and drainer. There is space and plumbing for a freestanding cooker, washing machine, and undercounter fridge, along with a UPVC window offering an attractive outlook over the rear garden.

The sitting room is situated at the front of the property and enjoys a bright double aspect with a feature bay window, a TV aerial point, and carpeted flooring.

The dining room benefits from a bright south-westerly aspect, with double casement doors leading out to the garden and stairs leading to the first floor landing.

First floor landing with a UPVC window with plantation shutters and an airing cupboard with slatted shelving and an electric bar heater.

The master bedroom is located at the rear of the property and is a generous double room with a built-in wardrobe, hatch to the loft space, and plantation shutters.

Bedroom two is situated at the front and is a bright double room with timber effect flooring.

Bedroom three is a single room, ideal as a child's bedroom or home office.

The family bathroom is fitted with a modern white suite comprising a WC, pedestal wash hand basin with mixer tap, and a panelled bath with independent thermostatic shower attachment, glass shower screen, tile effect flooring, part tiled walls, and recessed ceiling spotlights.





## *Gardens & Grounds*

To the front of the property is a private front garden with a tarmac driveway giving access to the single garage with a pitched tiled roof, up and over door, power and lighting. The remainder of the front garden is laid to lawn with attractive picket fencing.

The rear garden has a bright south westerly aspect with a summerhouse, potting shed, attractive pergola with decking making a lovely area for outside entertaining, with the rest of the garden laid to lawn with high shrubs and fencing making it extremely private and secluded.

## *Services*

- Mains gas, electricity, drainage and water
- Council Tax Band: D
- Energy Performance Rating: C

EST.

### Ground Floor

Approx. 40.2 sq. metres (433.0 sq. feet)

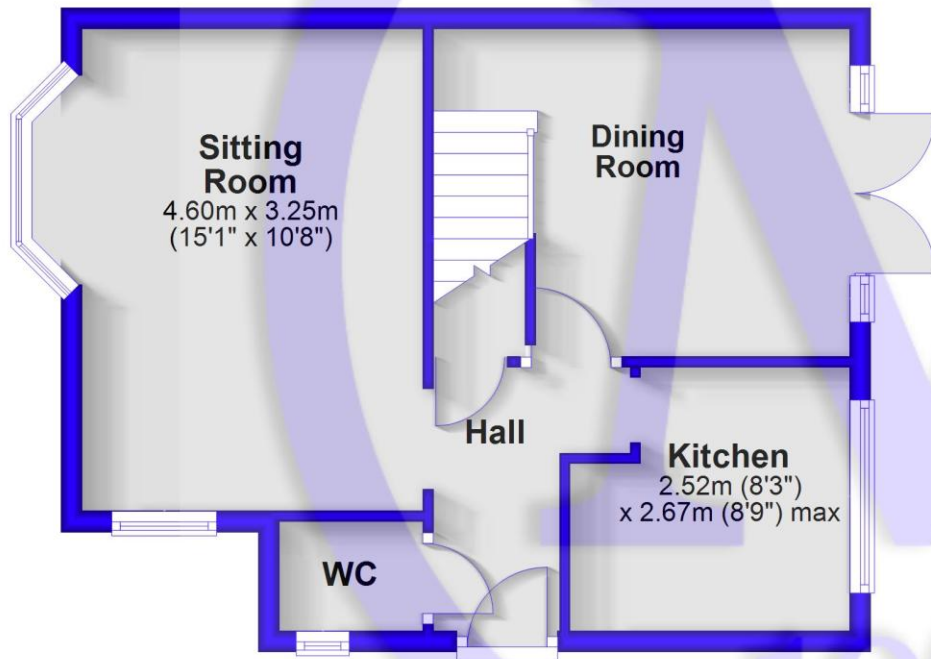

### First Floor

Approx. 38.0 sq. metres (409.3 sq. feet)

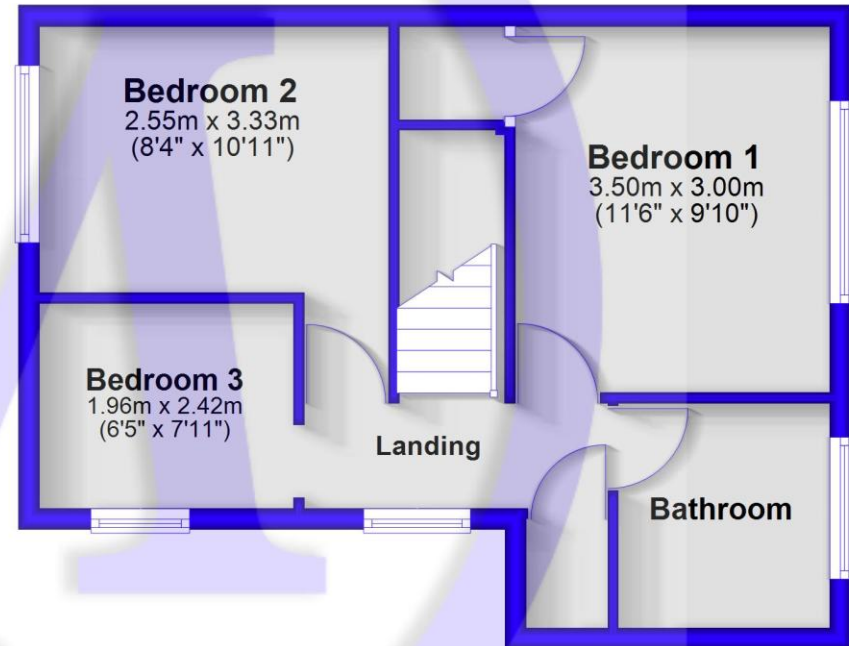

1963

Total area: approx. 78.3 sq. metres (842.3 sq. feet)



## Situation

New Milton is a thriving market town situated on the western edge of Hampshire, enjoying a prime location along a picturesque stretch of the Solent coastline. The area offers stunning views across Christchurch Bay to the Isle of Wight and is renowned for its beautiful coastal walks. With a mainline railway station providing direct access to London Waterloo in under two hours, the town is perfectly positioned for commuters and those seeking a coastal lifestyle. New Milton also boasts excellent state and private schools, a 27-hole links-style golf course, and the renowned Chewton Glen Hotel, making it an exceptionally popular destination for those looking to relocate to the coast.

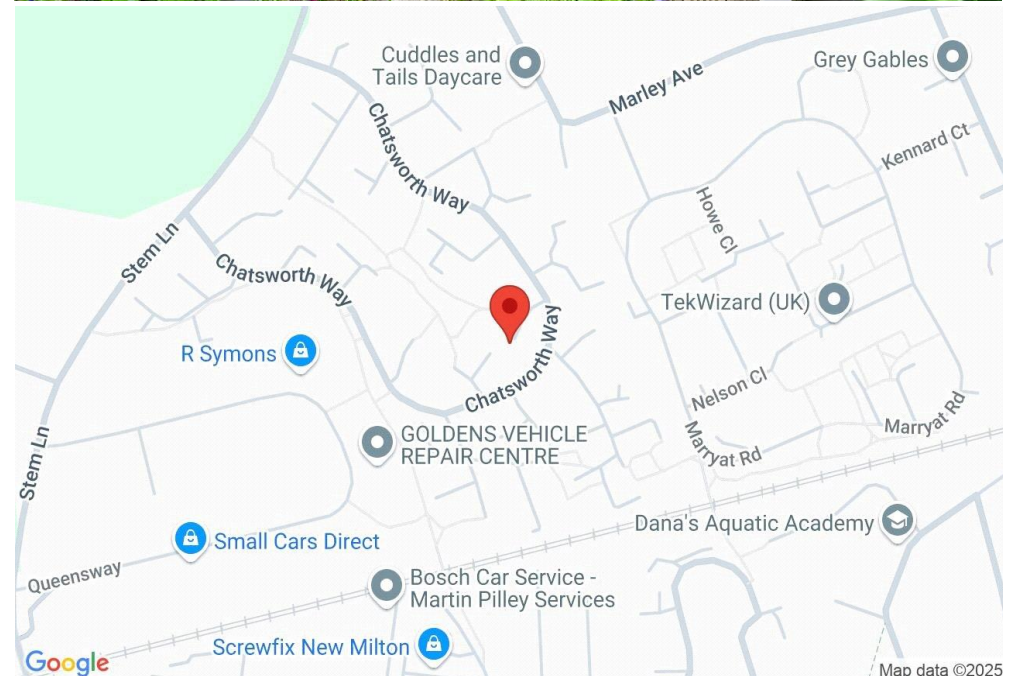



[Mitchells.uk.com](http://Mitchells.uk.com)  
[info@mitchells.uk.com](mailto:info@mitchells.uk.com)  
01425 616411

Centenary Buildings  
8-10 Old Milton Road  
New Milton  
Hampshire  
BH25 6DT

**Mitchells**  
1963 — TODAY

