



*12 Meadowsweet Close, Highcliffe on Sea, BH23 4FY*

*£625,000*

**Mitchells**  
1963 — TODAY





# *Meadowsweet Close, Highcliffe on Sea*

A simply stunning “as new” three bedroom, two bathroom detached luxury bungalow of about 1200 sqft on a generous size plot. Built about three years ago to traditional standards and still in immaculate condition, this beautiful home is situated in one of the smartest cul de sacs on the forever popular Hoburne Farm development, close to Sainsburys superstore, Stewarts Garden Centre and within walking distance of Friars Cliff beach. Also featuring beautiful gardens and a double garage. Properties like this are rarely available in Highcliffe.

- THREE BEDROOMS • TWO BATH/SHOWER ROOMS (ONE EN-SUITE) • KITCHEN/BREAKFAST ROOM • UTILITY ROOM • DINING AREA • LIVING ROOM • DOUBLE GARAGE • GARDENS • OFF-ROAD PARKING •





## The Property

- Three bedrooms
- Two bathrooms
- Fabulous high quality, well planned kitchen/diner
- lovely separate sitting room
- Good size utility room
- Gas CH, energy efficient build specification and private solar panels generating hot water
- Stylish low maintenance exterior elevations
- Attractive side patio
- Beautiful rear garden with further patios and pergola, maturing pleach trees, Thuja hedging and evergreen Clematis providing screening and a haven for birds and bees
- Plenty of off-road parking
- Double garage with walls & ceiling plaster-boarded & insulated making it suitable for conversion if required
- Useful garden shed and bin storage area
- EPC 'B'
- Council Tax 'E' £2658.58







## Location

Highcliffe is a small village in the borough of Christchurch, Dorset. The village lies on a picturesque stretch of Solent coastline with views over Christchurch Bay to the Isle of Wight. Fuelled by its enviable location, coastal walks, main line railway links to London (in under two hours) excellent schools and the popularity of the Chewton Glen Hotel, the Highcliffe Golf Course and the Nature Reserve at Steamer Point, Highcliffe is a popular area for those relocating to the coast.

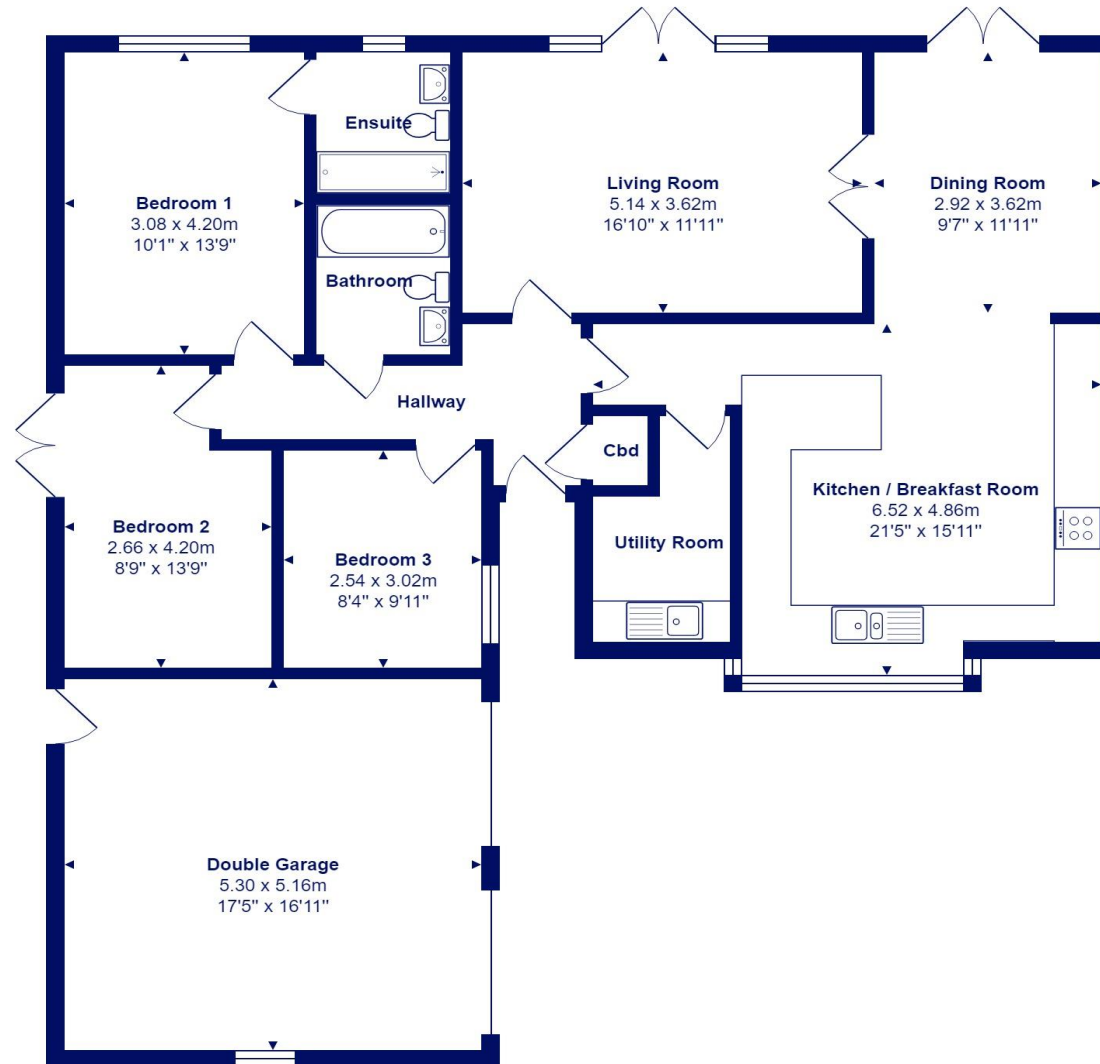

Total Area: 110.4 m<sup>2</sup> ... 1188 ft<sup>2</sup> (excluding double garage)

All measurements are approximate and for display purposes only









[mitchells.uk.com](http://mitchells.uk.com)  
[highcliffe@mitchells.uk.com](mailto:highcliffe@mitchells.uk.com)  
01425 272206

Highcliffe  
284 Lymington Road  
Highcliffe  
BH23 5ET

