



5 Sea Road, Barton on Sea, BH25 7NA

£450,000

Mitchells
1963 — TODAY



*5 Sea Road
Barton on Sea
New Milton
Hampshire
BH25 7NA*

This highly deceptive three/four bedroom detached bungalow is ideally situated a short walk of the local bus stop and walking distance of Barton On Sea clifftop and beach. The property offers versatile accommodation with features including master bedroom with ensuite, double aspect sitting room, spacious kitchen, separate dining room/bedroom four, impressive conservatory and a private and secluded garden.

- Entrance Hall
- Three Bedrooms
- Ensuite Shower Room
- Family Bathroom
- Dining Room/Bedroom Four
- Separate Sitting Room
- Kitchen
- Conservatory
- Driveway
- Private & Secluded Garden



The Property

Entrance hall with hatch to roof space, central heating controls, double radiator and airing cupboard.

The sitting room has a bright double aspect, TV aerial point, radiator, ample space for three piece suite and an archway leads through to the dining room/bedroom four.

The dining room has a UPVC window, ample space for a four to six seater table and chairs and a glazed panel door leading back to the hallway.

The kitchen is fitted with a range of solid wood wall and base units with a contrasting granite effect worktop, UPVC door leads out to a pathway and rear garden, one and a half bowl sink with mixer tap over and drainer and space and plumbing for a free standing cooker and tall stand up fridge freezer, a tiled splash back and UPVC window.

The impressive conservatory has a twin polycarbonate pitched roof, UPVC windows, dwarf cavity brick wall, double radiator and double casement doors leading out to the rear garden. There is also a useful utility area with space and plumbing for a tumble dryer and washing machine and there is a UPVC door leading out to the side path and garden.

There are three double bedrooms all giving ample space for double beds and furniture with bedrooms one and two enjoying an outlook to the front and the master bedroom benefitting from an ensuite shower room.

The ensuite shower room has a pedestal wash hand basin, WC, shower cubicle with thermostatic shower attachments and glass shower screen, fully tiled walls and extractor fan.

The family bathroom is particularly spacious with a suite comprising a WC, pedestal wash hand basin, panel bath with mixer tap over and hand held shower attachment, large UPVC window, radiator and towel rail.





Gardens & Grounds

The front of the property has dwarf wall with a large area of lawn surrounded by mature hedging and driveway giving off road parking for two to three vehicles.

To the rear of the property is a private and secluded garden surrounded by high level fencing, a summerhouse, a storage shed and is laid to hard landscaping for ease of maintenance.

The property is highly deceptive and must be viewed to fully appreciate the accommodation on offer.

Services

- Mains gas, electric, drainage and water
- Council Tax Band D
- Energy Performance Rating D



Floor Plan

Approx. 112.0 sq. metres (1205.2 sq. feet)

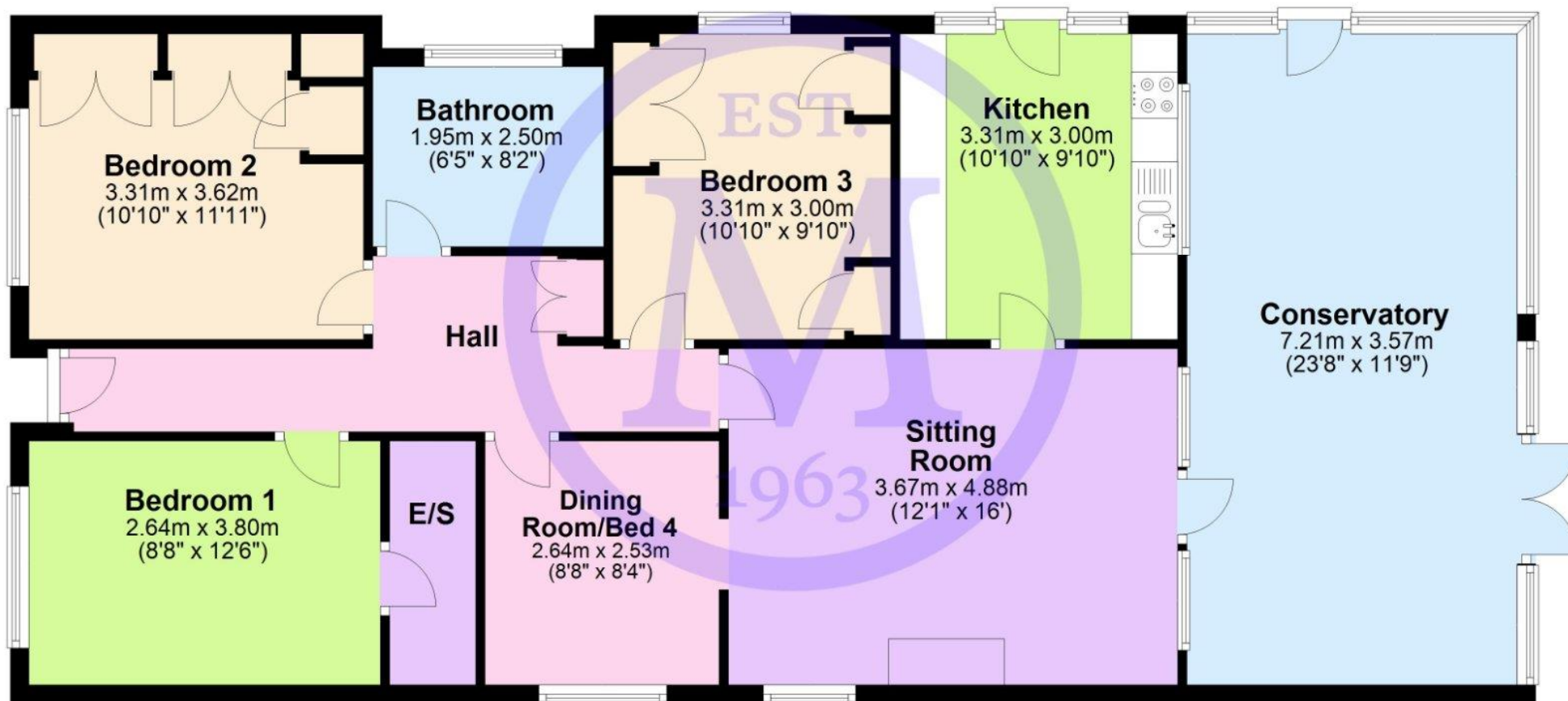

'Whilst every attempt has been made to ensure the accuracy of this floor plan, the measurements of doors, windows, rooms and any other items are approximate and no responsibility is taken for any error, omission or mis-statement. This plan is for illustrative purposes only and should be used as such by any prospective purchaser.'

Plan produced using PlanUp.

5 Sea Road, Barton On Sea

Situation

Barton on Sea is a suburb of New Milton and occupies an enviable position on a picturesque stretch of the Solent coastline with stunning views over Christchurch bay to the Isle of Wight and beautiful coastal walks in both directions. Fuelled by its excellent location, the nearby open forest of the New Forest National Park, main line rail links to London Waterloo, quality schooling, luxury restaurants including the renowned Chewton Glen hotel and Pebble Beach on the cliff top, a links style 27 hole golf course, Barton on Sea is an extremely popular choice for those relocating to the coast.

Directions

From Mitchells proceed along Old Milton Road. At the roundabout continue straight across and upon reaching the T-Junction turn right onto Christchurch Road. After approximately half a mile turn left into Sea Road where the property will be seen on the left hand side.





Mitchells.uk.com
info@mitchells.uk.com
01425 616411

Centenary Buildings
8-10 Old Milton Road
New Milton
Hampshire
BH25 6DT

Mitchells
1963 — TODAY

