



*14 Pinewood Road, Highcliffe on Sea, BH23 5PJ*

*£795,000*

**Mitchells**  
1963 — TODAY



# *14 Pinewood Road, Highcliffe on Sea*

A first class bungalow on the Holmhurst Development which has been significantly and skilfully extended, now boasting about 1375sqft of luxury living space and standing on a glorious plot with a large driveway and fantastic rear garden. This superb bungalow is immaculate inside and out and the current owners have refurbished the property throughout. There is now a superior master bedroom with stylish en-suite shower room and in addition to the L shaped sitting/dining room, there is now a new kitchen that leads onto a very smart family/dining space. The heating and wiring have all been updated and a newly laid resin bound driveway and patio really sets the bungalow off. The garden is a real stand out feature being completely level, mainly laid to lawn with a boardwalk taking you to a raised sun deck with pergola, perfect for outdoor entertaining.

- **THREE BEDROOMS • TWO BATH/SHOWER ROOMS • (ONE EN-SUITE) • KITCHEN • FAMILY ROOM • LOUNGE/DINER**
- **GARAGE • GARDENS • OFF-ROAD PARKING •**



## The Property

- Quality detached bungalow, traditionally built and forming part of the Holmhurst Development, close to Cranemoor Common
- Original and restored wood block flooring to the hall, sitting/dining room and two bedrooms
- Large picture window and French doors from the main living room to the gardens, log burner
- Three spacious double bedrooms with two refitted bath/shower rooms finished with designer sanitary ware
- Contemporary fitted kitchen with integrated appliances that leads to the semi-open plan family/dining area
- Gas fired central heating with a newly installed pressurised hot water system, UPVC double glazed windows
- Integral garage and an abundance of off-road parking
- A truly fabulous garden with a high degree of privacy and colourful shrub borders
- Council Tax 'E' £2658.58
- EPC 'D'





## Location

Highcliffe is a small village in the borough of Christchurch, Dorset. The village lies on a picturesque stretch of Solent coastline with views over Christchurch Bay to the Isle of Wight. Fuelled by its enviable location, coastal walks, main line railway links to London (in under two hours) excellent schools and the popularity of the Chewton Glen Hotel, the Highcliffe Golf Course and the Nature Reserve at Steamer Point, Highcliffe is a popular area for those relocating to the coast.



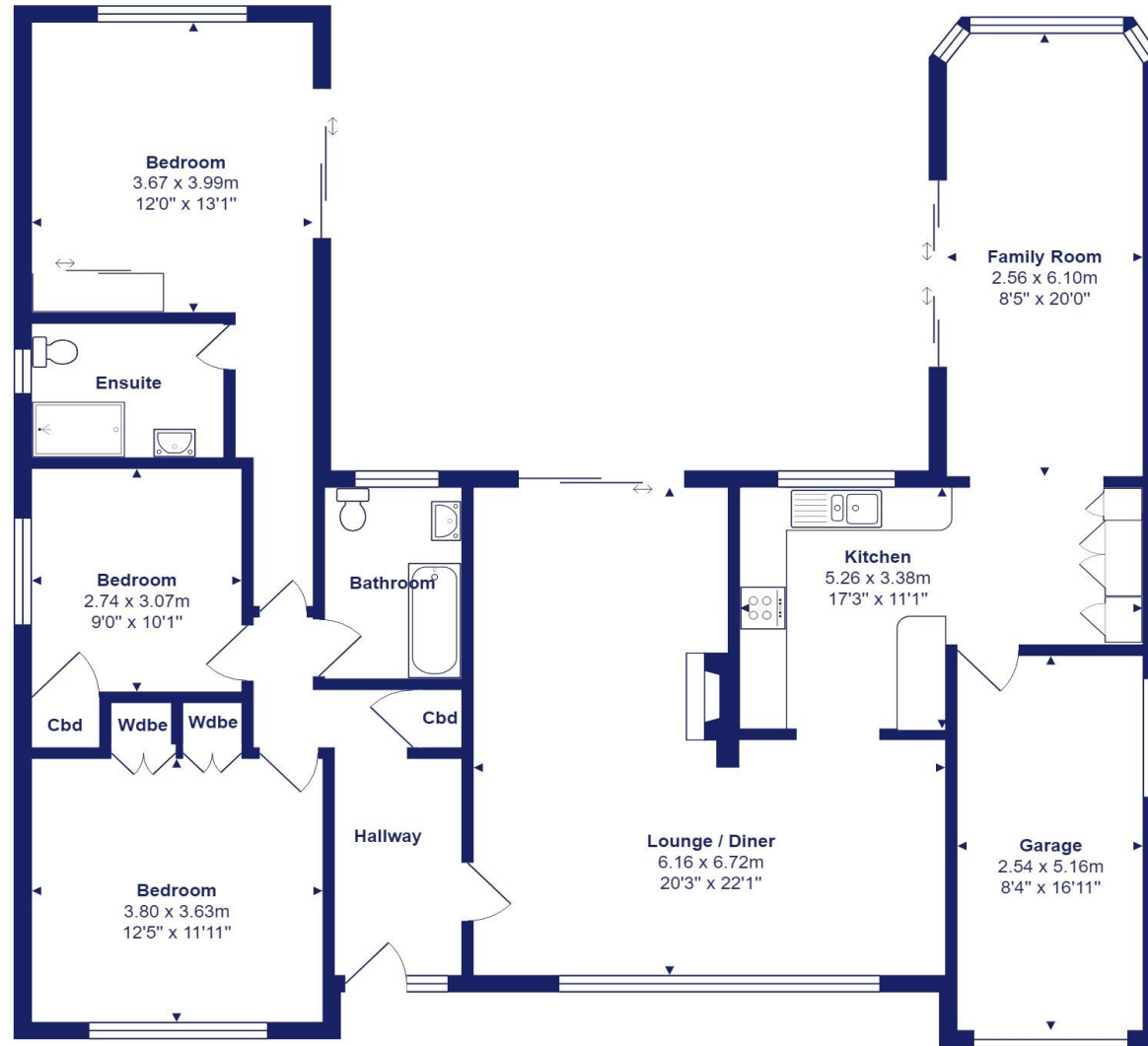

Total Area: 127.6 m<sup>2</sup> ... 1374 ft<sup>2</sup> (excluding garage)

All measurements are approximate and for display purposes only







[mitchells.uk.com](http://mitchells.uk.com)  
[highcliffe@mitchells.uk.com](mailto:highcliffe@mitchells.uk.com)  
01425 272206

Highcliffe  
284 Lymington Road  
Highcliffe  
BH23 5ET

