

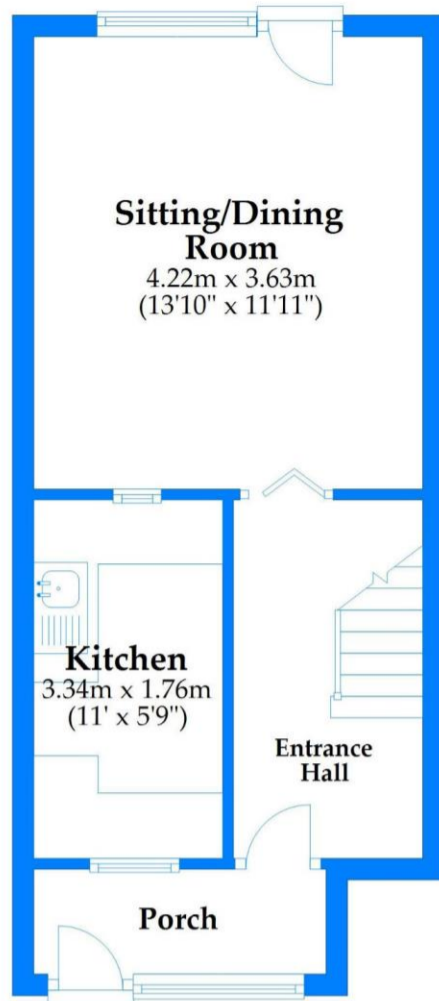

### Ground Floor

Approx. 30.7 sq. metres (330.8 sq. feet)



### First Floor

Approx. 27.8 sq. metres (299.1 sq. feet)

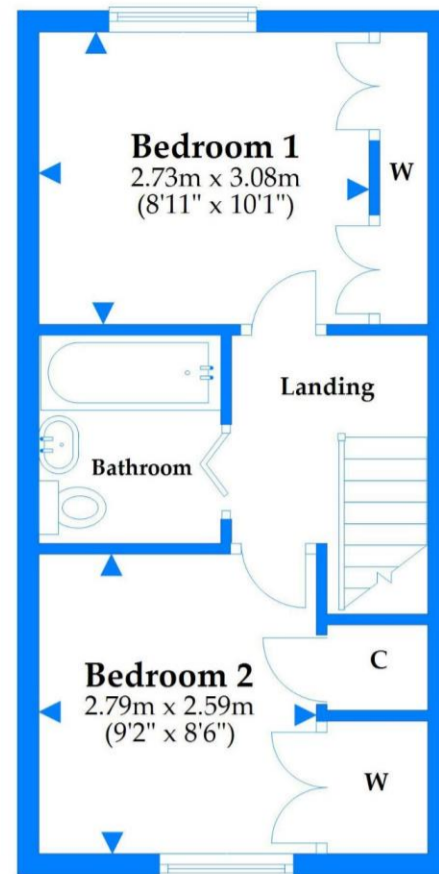

Total area: approx. 58.5 sq. metres (629.9 sq. feet)

This plan is not to scale and it is for general guidance only. LJT Surveying Ltd Ringwood  LJT SURVEYING



Rodney Drive, Mundeford, BH23 3LL

£279,950 Asking Price

**Mitchells**  
1963 — TODAY

# Rodney Drive

## Mudford, Christchurch, BH23 3LL

A delightful mid-terrace, two double bedroom property situated in the heart of Mudford with driveway parking and a sunny south-west facing garden. Offering scope for improvement this home is offered for sale with vacant possession. Located within the catchment area of the local sought after schools, local shops, bus routes and within walking distance of Mudford Quay and beaches.

- Mid-terrace house with 630 sq.ft. of accommodation
- Two double bedrooms
- Sitting/dining room with outlook to the garden
- Good sized kitchen
- uPVC double glazing & gas fired central heating
- Family bathroom to the first floor
- South-west facing rear garden with storage shed
- Driveway parking at the front
- Close to local shops, bus routes and within catchment area of local schools
- Council Tax Band 'C' - £1971.54
- EPC rating 'C'

