

14 THISTLE CLOSE
HIGHCLIFFE ON SEA, BH23 4UP





14 THISTLE CLOSE, HIGHCLIFFE ON SEA

An immaculate detached house of about ...sq ft on the hugely popular Hoburne Farm Development, traditionally built and enjoying a lovely garden that has been professionally landscaped. Quietly situated in this tucked away close, within the catchment area for both local schools and within walking distance of the local shops and Friars Cliff beach. The current owners have kept the house beautifully and have replaced the kitchen and utility room with contemporary units with quality appliances. The two generous reception rooms both look out onto the rear garden with the UPVC conservatory extension really complimenting the living space. There are four bedrooms upstairs with a very smart en-suite shower room and wardrobes to bedroom one and an additional fully tiled bathroom that services the other three rooms. The gardens have been laid out with ease of maintenance in mind with the rear garden enjoying the perfect aspect for afternoon/evening sunshine with a double garage and driveway giving parking for four cars.

- FOUR BEDROOMS • TWO BATH/SOWER ROOMS • LOUNGE • DINING ROOM • CONSERVATORY • GF WC • OFF-ROAD PARKING • GARDENS • DOUBLE GARAGE •



The Property

- First class decorative order and modern fittings throughout
- Bright and spacious lounge
- UPVC conservatory extension
- Separate dining room
- Gas fired central heating and UPVC double glazed windows, UPVC fascia's, soffits and guttering
- Attractive outlook to the front
- A very pretty and well established rear garden with artificial grass and patios
- Easy access to Sainsburys, bus routes and with Highcliffe and Christchurch being about two miles distant respectively
- Perfect accommodation for family or retirement living
- Vendors suited with an onward purchase
- Council Tax 'E' £2531.29
- EPC TBC





Location

Highcliffe is a small village in the borough of Christchurch, Dorset. The village lies on a picturesque stretch of Solent coastline with views over Christchurch Bay to the Isle of Wight. Fuelled by its enviable location, coastal walks, main line railway links to London (in under two hours) excellent schools and the popularity of the Chewton Glen Hotel, the Highcliffe Golf Course and the Nature Reserve at Steamer Point, Highcliffe is a popular area for those relocating to the coast.

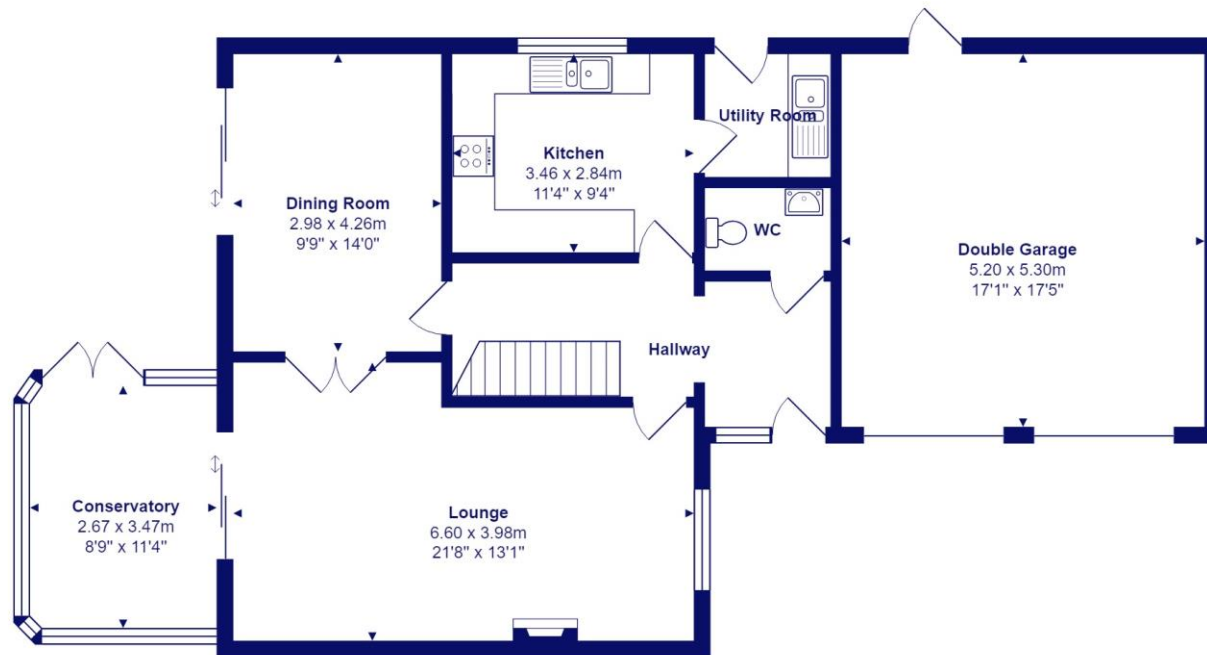

Ground Floor



First Floor



Total Area: 160.1 m² ... 1723 ft²

All measurements are approximate and for display purposes only







284 Lymington Road, Highcliffe on Sea, Christchurch, Dorset, BH23 5ET highcliffe@mitchells-estateagents.co.uk

01425 272206

mitchells.uk.com