



177 Seabreeze, Shorefield Country Park, SO41 0LH

£59,950

Mitchells
1963 — TODAY



*177 Seabreeze
Shorefield Country Park
Downton Lane
Lymington
SO41 0LH*

This fantastic two bedroom luxury holiday home is ideally situated in an elevated position at Shorefield Country Park and within a short walk of all amenities. The property has been beautifully maintained and offers bright and spacious accommodation with features including open plan living, two luxury bathrooms, spacious decking and parking.

- Hallway
- Sitting Room
- Kitchen/Dining Room
- Two Bedrooms
- Shower Room
- Ensuite Bathroom
- Walk In Wardrobe
- Private Decking
- Parking



The Property

Double casement doors leading to the kitchen/dining room with four seater table and chairs, shaker style wall and base units with contrasting stone effect worktop and integrated appliances include an under counter double oven, dishwasher, washing machine, wine cooler, four burner gas hob, sink with mixer tap over and drainer, splash back, built in microwave, and under counter fridge and separate freezer, has wood effect flooring, two Velux windows with built in blinds, UPVC window and this opens through to the sitting room.

The sitting room has a bright double aspect with double casement doors leading out to the balcony, floor to ceiling windows, built in sound system, fireplace with timber mantle and built in electric fire, TV aerial point and three piece suite consisting of two arm chairs and a bed settee.

Internal hallway with recess ceiling spotlights and radiator.

Main shower room with modern suite comprising a wash hand basin with mixer tap over and storage beneath, mirror fronted medicine cabinet, WC with hidden cistern, walk in double shower with glass shower doors and thermostatic shower attachments, under floor heating, UPVC window, retractable extractor fan and cupboard housing the central heating boiler.

Bedroom two is a twin bedroom currently set up with bunk beds, UPVC window, wall mounted storage, built in wardrobe, radiator and TV aerial point.

The master bedroom is a particular feature of this property with king sized bed that lifts up for storage beneath, cupboard, built in TV, built in dressing table and walk in wardrobe.

The walk in wardrobe has hanging, chest of drawers and lighting.

The ensuite bathroom is a lovely size with suite comprising a pedestal wash hand basin with mixer tap over, WC, bath with mixer tap over, shower attachment with fold out glass shower screen, mirror fronted medicine cabinet, shaver point, underfloor heating, UPVC window and retractable extractor fan





Gardens & Grounds

Large raised decking to the front and side of the property.

Two parking spaces.

Two storage units.

Services

- Mains gas, electric, drainage and water
- Council Tax Band
- Energy Performance Rating To be confirmed

Floor Plan

Approx. 53.3 sq. metres (574.0 sq. feet)

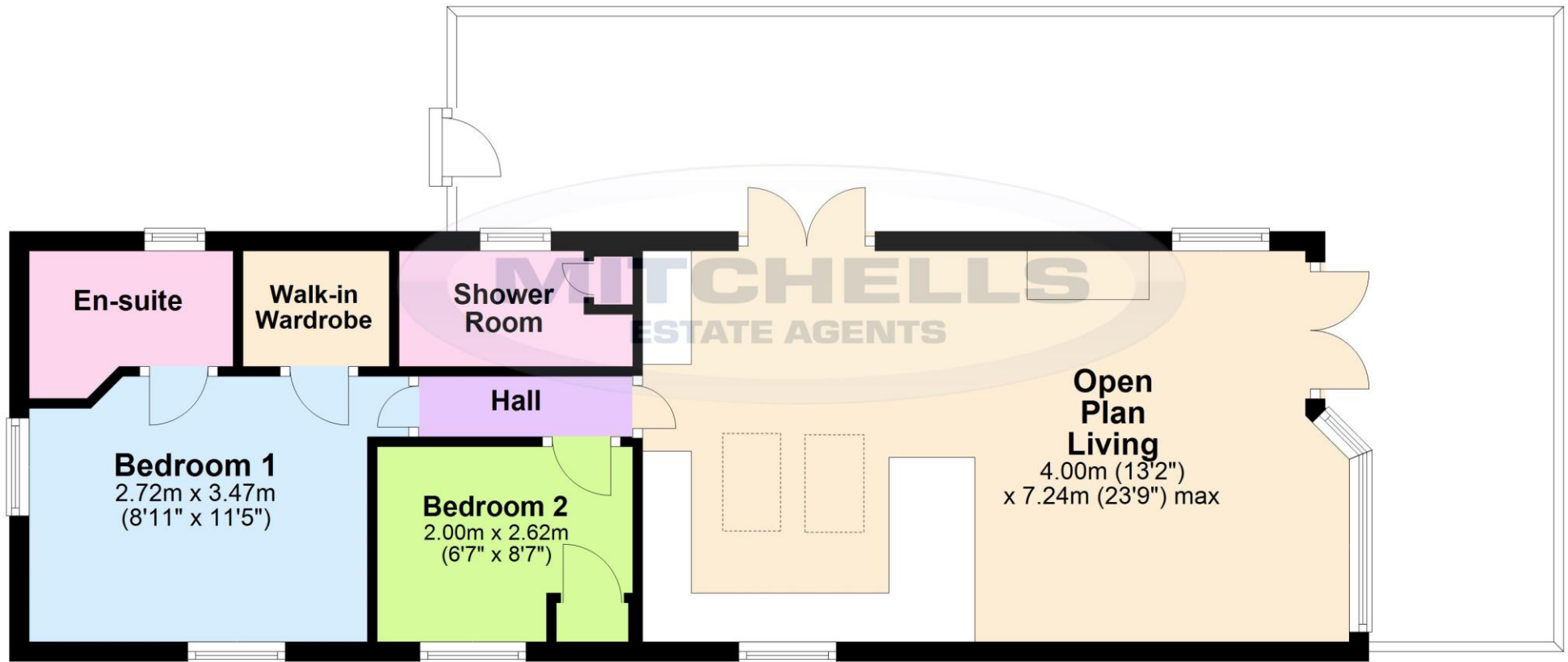

'Whilst every attempt has been made to ensure the accuracy of this floor plan, the measurements of doors, windows, rooms and any other items are approximate and no responsibility is taken for any error, omission or mis-statement. This plan is for illustrative purposes only and should be used as such by any prospective purchaser.'

Plan produced using PlanUp.

177 Seabreeze, Shorefield Park, Lymington

Situation

Situated on the southern edge of the New Forest National Park, and just a short stroll away from the shingled shores of the beach at Milford on Sea, the award winning Shorefield Country Park is a fantastic position to own the ultimate bolthole. Facilities include heated indoor and outdoor pools, gym and day spa, bars, restaurant, fishing lake, pet friendly areas, play areas, tennis courts and live family entertainment.

Directions

From Mitchells turn right at the traffic lights and proceed down Station Road. Across at the roundabout onto Milford Road and continue for approximately one and a half miles. Turn left into Downton Lane, right into Shorefield Park, passing the clubhouse on the left and as you approach the barriers continue over the roundabout and follow the signage to 177 Seabreeze.





Mitchells.uk.com
info@mitchells.uk.met
01425 616411

Centenary Buildings
8-10 Old Milton Road
New Milton
Hampshire
BH25 6DT

Mitchells
1963 — TODAY

