

HALIFAX WAY
MUDEFORD, BH23 4TX





£369,950 FREEHOLD

A very well presented mid-terrace house situated on this popular development within the catchment area of the local schools and within walking distance of the beach at Friars Cliff.

This lovely home features an entrance hall, lounge/diner with feature bay window, modern kitchen, three bedrooms, a refitted family bathroom, sunny rear garden and a garage in a nearby block.

THREE BEDROOMS • FAMILY BATHROOM • MODERN KITCHEN • LOUNGE/DINING ROOM
GARDEN • STORAGE SHED
GARAGE IN NEARBY BLOCK • CASUAL PARKING NEARBY



The Property

- Mid-terrace property of approx. 715 sq ft
- Three bedrooms
- Refitted family bathroom
- Good size lounge/dining room with feature bay window and doors onto the garden
- Modern kitchen
- Well landscaped and sunny rear garden with storage shed
- Garage in a nearby block
- Casual parking nearby
- Gas fired central heating and UPVC double glazed windows
- Council Tax Band 'C' - £1861.25
- EPC rating 'D'





Location

Mudford began as a small fishing village close to the entrance of Christchurch Harbour which still sees fishing boats landing their catch today. The area enjoys award winning sandy beaches at Avon beach and plenty of wildlife activity on Hengistbury Head and Stanpit Marsh Nature Reserve. The popular Mudford Sandbank attracts visitors every year to the private beach huts with the Harbour providing a sheltered environment for watersports activities. With a friendly, community feel, it is no wonder Mudford is becoming a popular choice for relocation.

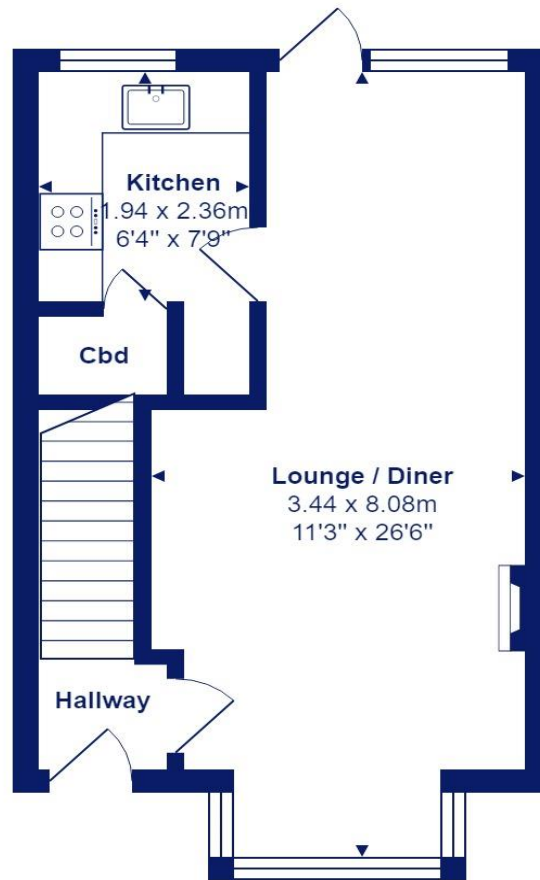

Ground Floor

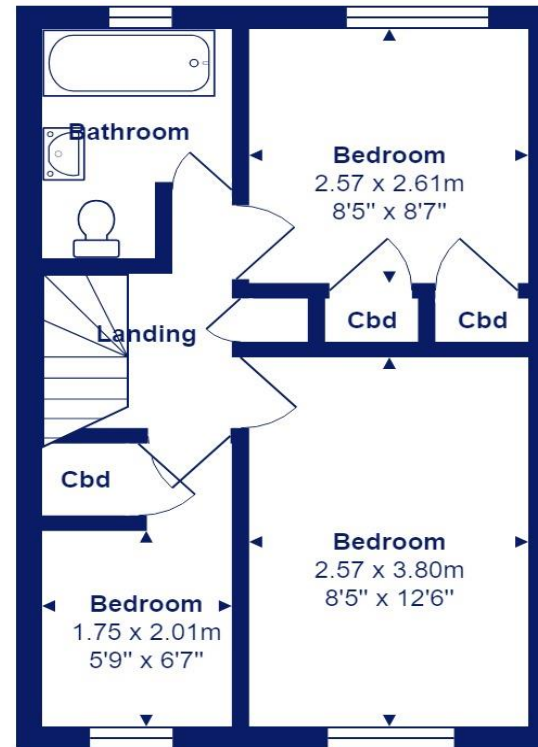

First Floor



Total Area: 66.0 m² ... 711 ft²

All measurements are approximate and for display purposes only





Cambridge House, 112-114 Stanpit, Christchurch, Dorset BH23 3ND mudford@mitchells-estateagents.co.uk

01202 499295
mitchells.uk.com