

7 BRYANT CLOSE
CHRISTCHURCH, BH23 2FL





£480,000 FREEHOLD

Presented in 'as new' condition is this extremely smart town house of about 1010sqft, built in 2014 but refurbished internally to a superb specification not normally seen with houses at this price point. Situated in this very quiet, tucked away position yet within easy reach of Christchurch town centre, the house is also incredibly energy efficient benefitting from a newly installed air source heat pump. The current owners have tastefully updated the inside of this house with high end fittings and it is now immaculate throughout. As soon as you walk through the front door you can see the quality of the finish with Karndean flooring on the ground floor that also has underfloor heating. The kitchen has been replaced with contemporary units with quartz tops and features top end appliances including a Quooker boiling water tap. This house is in show home order and the owners are suited with an onward purchase. Strongly recommended.

- THREE BEDROOMS • TWO BATH/SHOWER ROOMS (ONE EN-SUITE) • FAMILY BATHROOM • KITCHEN • LOUNGE/DINER • GF WC • GARDENS • TWO ALLOCATED PARKING SPACES •



The Property

- Attractively designed townhouse that forms part of this select development in this quiet location
- Very convenient with the local parade of shops on Barrack Road just around the corner
- Plantation style shutters and quality curtains included in the purchase price
- With en-suite shower room and fitted wardrobes in the main bedroom on the first floor
- Spacious sitting/dining room with access onto the rear garden
- Flat plastered ceilings, replacement internal doors and newly fitted carpets throughout
- Landscaped gardens with raised decked area and space to the side suitable for garden shed/studio
- Two allocated parking spaces in front of the house, communal bike storage.
- Service charge for driveway, communal lighting, PL insurance etc approx. £200 p.a.- please speak to agents for further details on this
- Council Tax Band 'D' - £2093.92
- EPC 'C'





Location

Christchurch is a beautiful, vibrant and historic town with its 11th century priory, quay/harbour, ancient castle ruins and various shops, cafes, restaurants and bars. The Town is well served for transport links with a main line railway station to London/Waterloo being just under 2 hours and Bournemouth International Airport about 5 miles distant. Excellent infant, junior and senior schools are also within easy reach as is the stunning the New Forest National Park.

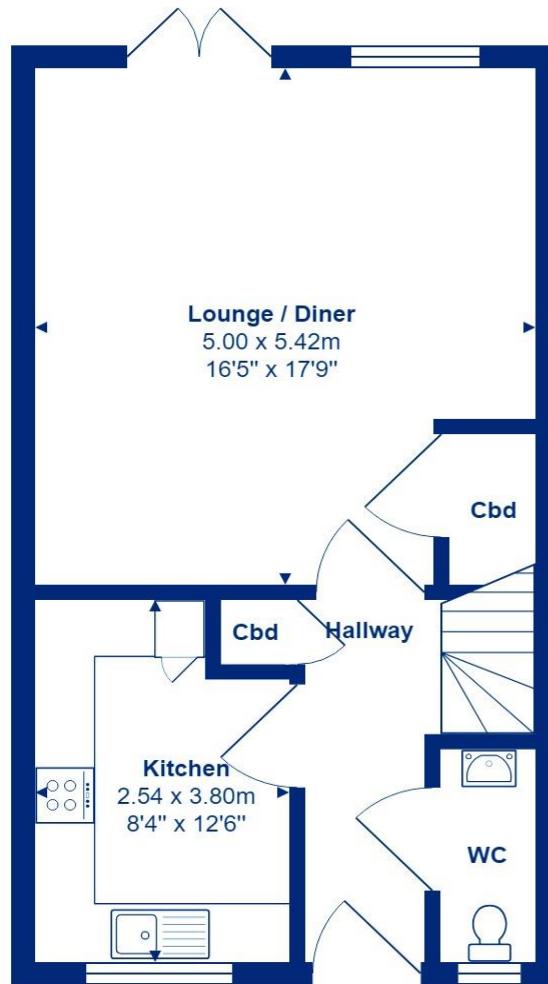

Ground Floor

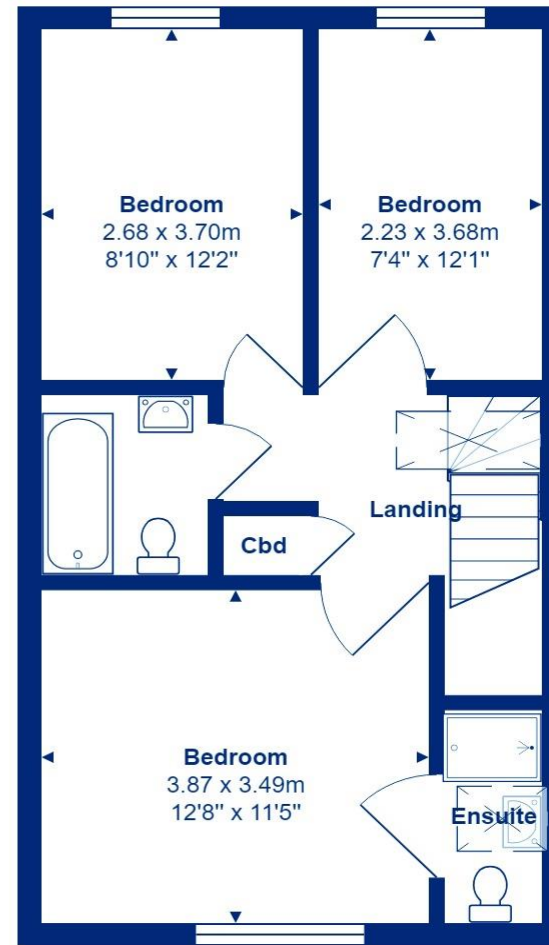

First Floor



Total Area: 93.8 m² ... 1010 ft²

All measurements are approximate and for display purposes only







Cambridge House, 112-114 Stanpit, Christchurch, Dorset BH23 3ND mudford@mitchells-estateagents.co.uk

01202 499295
mitchells.uk.com