



11 Heather Lodge, New Milton, BH25 6DF

£255,000

Mitchells
1963 — TODAY



*11 Heather Lodge
Whitefield Road
New Milton
Hampshire
BH25 6DF*

A fantastic two double bedroom, two bathroom ground floor apartment situated a few steps from the high street and the mainline station. Features of this property include a double aspect lounge/dining room, south facing balcony, master bedroom with en suite, garage, extended lease and the property is offered with vacant possession.

- Entrance Hall
- Sitting/Dining Room
- Kitchen
- Two Double Bedrooms
- Family Bathroom
- En-Suite Shower Room
- Balcony
- Garage
- Extended Lease
- Communal Gardens
- No Forward Chain



The Property

Spacious hallway with two useful storage cupboards, central heating thermostat, double radiator and telephone point.

Triple aspect sitting/dining room is a fantastic size with ample space for three piece suite and four seater table and chairs, has a bright southerly aspect and double glazed door leading out to the private balcony.

Balcony has wrought iron railings, a bright southerly aspect and enjoys views over the communal grounds.

The kitchen is fitted with a fantastic range of wall and base units with a contrasting worktop, a modern gloworm combination boiler and built in appliances include a double oven, four burner gas hob with extractor fan over, tiled splashback, one and a half bowl sink with mixer tap over and drainer and space and plumbing for a tall stand up fridge freezer, slimline dishwasher and washing machine.

The family bathroom is a lovely size with suite comprising a pedestal wash hand basin with mixer tap over, WC, panel bath with mixer tap over and hand held shower attachment, glass shower screen, fully tiled walls and tiled flooring.

The master bedroom is a large double aspect room with lots of built in furniture, space for king sized bed and bedside cabinets, has a bright double aspect and its own ensuite shower room.

The ensuite comprises of a double walk in shower with thermostatic shower attachment, pedestal wash hand basin with mixer tap over, WC, heated towel rail, UPVC window and fully tiled walls.

Bedroom two is a double bedroom with space for a double bed, bedside cabinets and wardrobes and enjoys an outlook to the front of the property.





Gardens & Grounds

To the front of the property is an area of communal garden that is beautifully maintained and the maintenance of which is paid for out of the annual maintenance charge.

To the rear of the property are the garages and this property benefits from a single garage with an electric up and over door, a further drying area and casual parking.

The property is offered with vacant possession and benefits from a long lease.

Services

- Mains gas, electric, drainage and water
- Council Tax Band D
- Energy Performance Rating D

Ground Floor

Approx. 75.1 sq. metres (808.6 sq. feet)

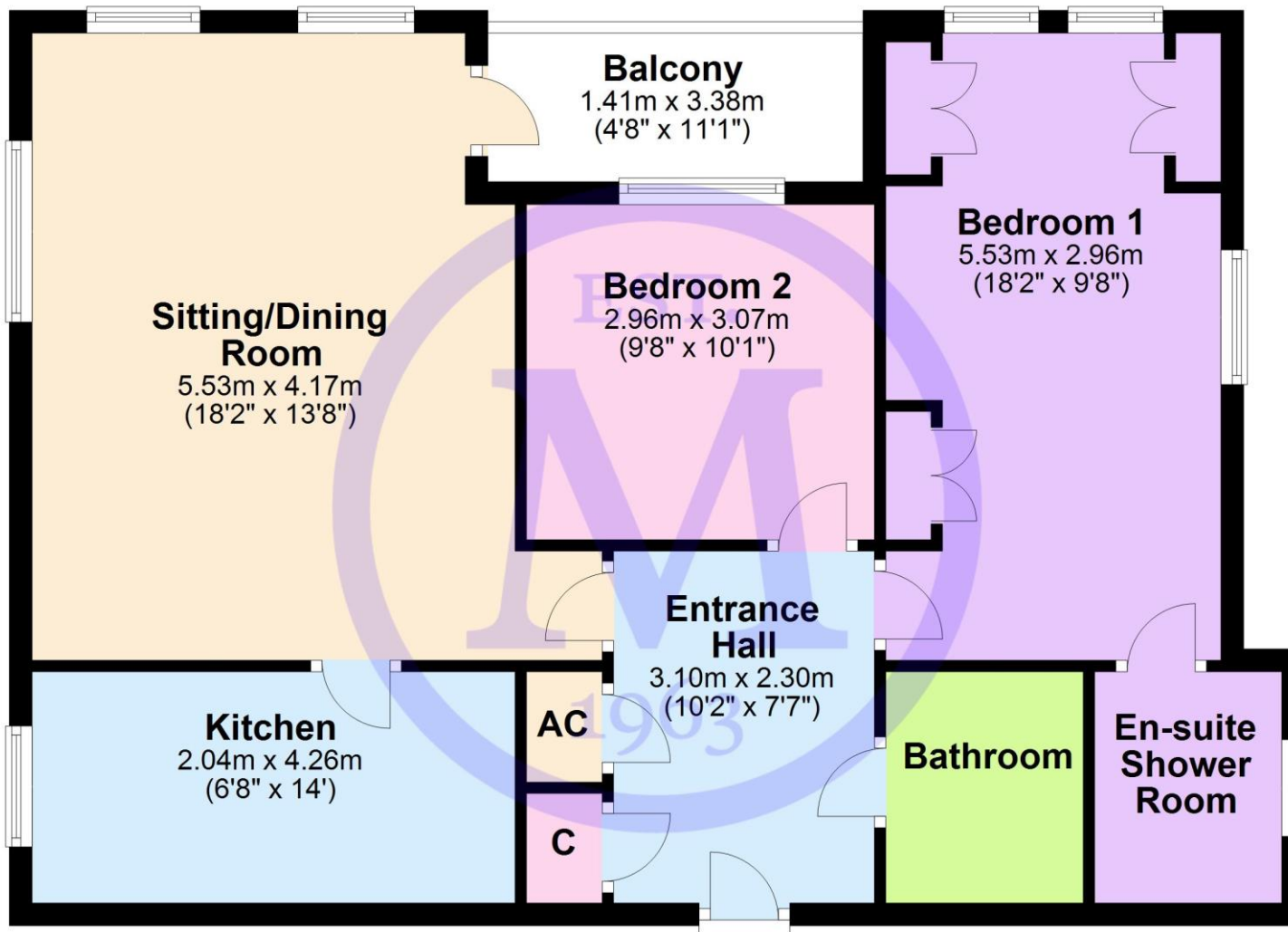

'Whilst every attempt has been made to ensure the accuracy of this floor plan, the measurements of doors, windows, rooms and any other items are approximate and no responsibility is taken for any error, omission or mis-statement.

This plan is for illustrative purposes only and should be used as such by any prospective purchaser.'

Plan produced using PlanUp.

11 Heather Lodge , Whitefield Road, New Milton

Situation

New Milton is a thriving market town on the western edge of Hampshire. The area lies on a picturesque stretch of the Solent coastline with stunning views over Christchurch Bay to the Isle of Wight. With the enviable location, beautiful coastal walks, main line railway station reaching London Waterloo in less than two hours, excellent schools, both private and state, 27 hole links style golf course and the renowned Chewton Glen hotel, New Milton remains an extremely popular location for those relocating to the coast.

Directions

From Mitchells proceed along Old Milton Road, at the roundabout turn right onto Whitefield Road, bear round to the right where the property will be seen immediately on your left hand side.





Mitchells.uk.com
info@mitchells.uk.com
01425 616411

Centenary Buildings
8-10 Old Milton Road
New Milton
Hampshire
BH25 6DT

Mitchells
1963 — TODAY

