



*"Crosswater" 6 Cranemoor Gardens, Highcliffe, BH23 5AW      £750,000*

**Mitchells**  
1963 — TODAY



# *Cranemoor Gardens, Highcliffe on Sea*

Crosswater is substantial five bedroom detached family home of approx 1800sqft of accommodation. The house has been very well maintained and enjoys lovely large room sizes with two separate reception rooms, a smart kitchen/diner and the useful ground shower room with wc. On the first floor there is an en-suite bathroom to the master bedroom and family bathroom. Standing on a glorious sunny plot with a good size garden to the rear, a long driveway provides plenty of off-road parking, double garage and pretty stream to the front. The property is close to the local shops at Saulflands with the high street, cliff top and beach being a little further on. Walking distance to Hinton Admiral main line railway station.

- FIVE BEDROOMS • THREE BATH/SHOWER ROOMS (ONE GF, ONE EN-SUITE) • KITCHEN/DINER • LOUNGE • PLAY ROOM/STUDY • ENTRANCE HALL • GARDENS • OFF-ROAD PARKING • DOUBLE GARAGE •



## The Property

- Spacious five bedroom detached house
- Three bath/shower rooms (one gf, one en-suite)
- Modern fitted kitchen/diner with views over the rear garden
- Bright and airy lounge with double aspect and feature log burner and access onto the gardens
- Separate play room/study
- Large entrance hall with storage
- Gas fired central heating, upvc double glazing & neutral décor throughout
- Good size rear garden with areas of lawn, shrubs, flower border and storage shed
- Off-road parking & double garage
- Highcliffe School's catchment area and close to local shops
- Council Tax 'F' £3141.96
- EPC 'C'





## Locatio

Highcliffe is a small village in the borough of Christchurch, Dorset. The village lies on a picturesque stretch of Solent coastline with views over Christchurch Bay to the Isle of Wight. Fuelled by its enviable location, coastal walks, main line railway links to London (in under two hours) excellent schools and the popularity of the Chewton Glen Hotel, the Highcliffe Golf Course and the Nature Reserve at Steamer Point, Highcliffe is a popular area for those relocating to the coast.



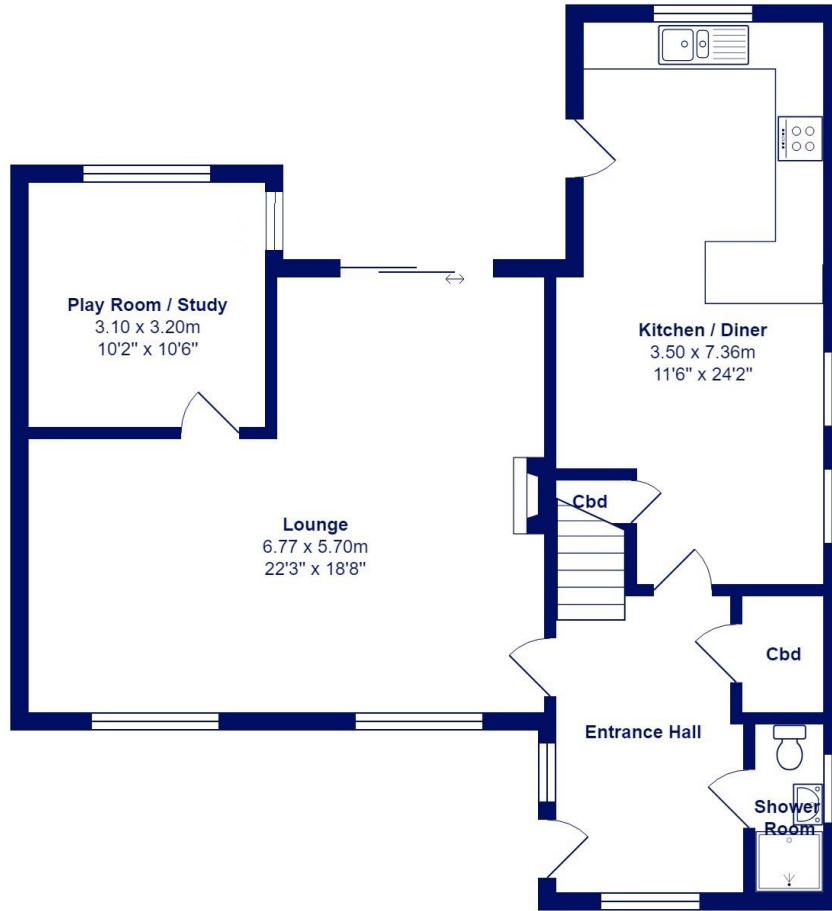

**Ground Floor**

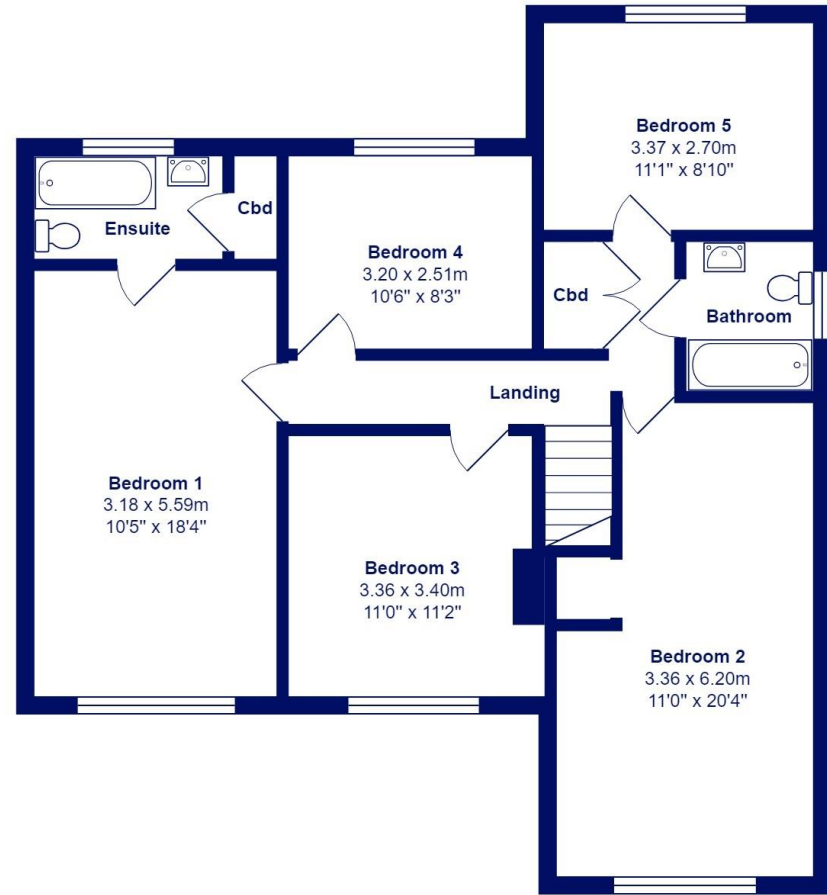

**First Floor**

All measurements are approximate and for display purposes only





[mitchells.uk.com](http://mitchells.uk.com)  
[highcliffe@mitchells.uk.com](mailto:highcliffe@mitchells.uk.com)  
01425 272206

Highcliffe on Sea  
284 Lymington Road  
Highcliffe on Sea  
BH23 4TH

