

2 BRAEMAR DRIVE
HIGHCLIFFE ON SEA, BH23 5NR





2 BRAEMAR DRIVE, HIGHCLIFFE ON SEA

A superb detached bungalow on the sought after Wolhayes Garden Estate that has been recently extended and modernised to an exceptional standard by the current owners. The property now offers spacious living accommodation of approximately 1250sqft with large private gardens, garage and ample off-road parking. Situated within easy walking distance to Hinton Admiral main line train station, Highcliffe high street and the areas award winning beaches just beyond.

- THREE BEDROOMS • TWO BATH/SHOWER ROOMS (ONE EN-SUITE) • KITCHEN/DINING/FAMILY ROOM • UTILITY ROOM • LOUNGE/BEDROOM THREE • GARAGE • GARDENS • OFF-ROAD PARKING •



The Property

- Two/three good size bedrooms, master with built-in wardrobes
- Two luxuriously appointed bath/shower rooms (one en suite)
- A fantastic large kitchen/dining/family room with Quartz worktops and integrated appliances
- Separate utility room
- Lovely lounge with feature fireplace or third bedroom if required
- Single garage and ample off-road parking
- Pretty secluded garden with well established borders and a good size area patio ideal for outdoor entertaining
- Home alarm & CCTV
- Easy access to the bustling high street, cliff top and beach
- Viewing highly recommended
- EPC 'C'
- Council Tax 'E' £2531.029





Location

Highcliffe is a small village in the borough of Christchurch, Dorset. The village lies on a picturesque stretch of Solent coastline with views over Christchurch Bay to the Isle of Wight. Fuelled by its enviable location, coastal walks, main line railway links to London (in under two hours) excellent schools and the popularity of the Chewton Glen Hotel, the Highcliffe Golf Course and the Nature Reserve at Steamer Point, Highcliffe is a popular area for those relocating to the coast.



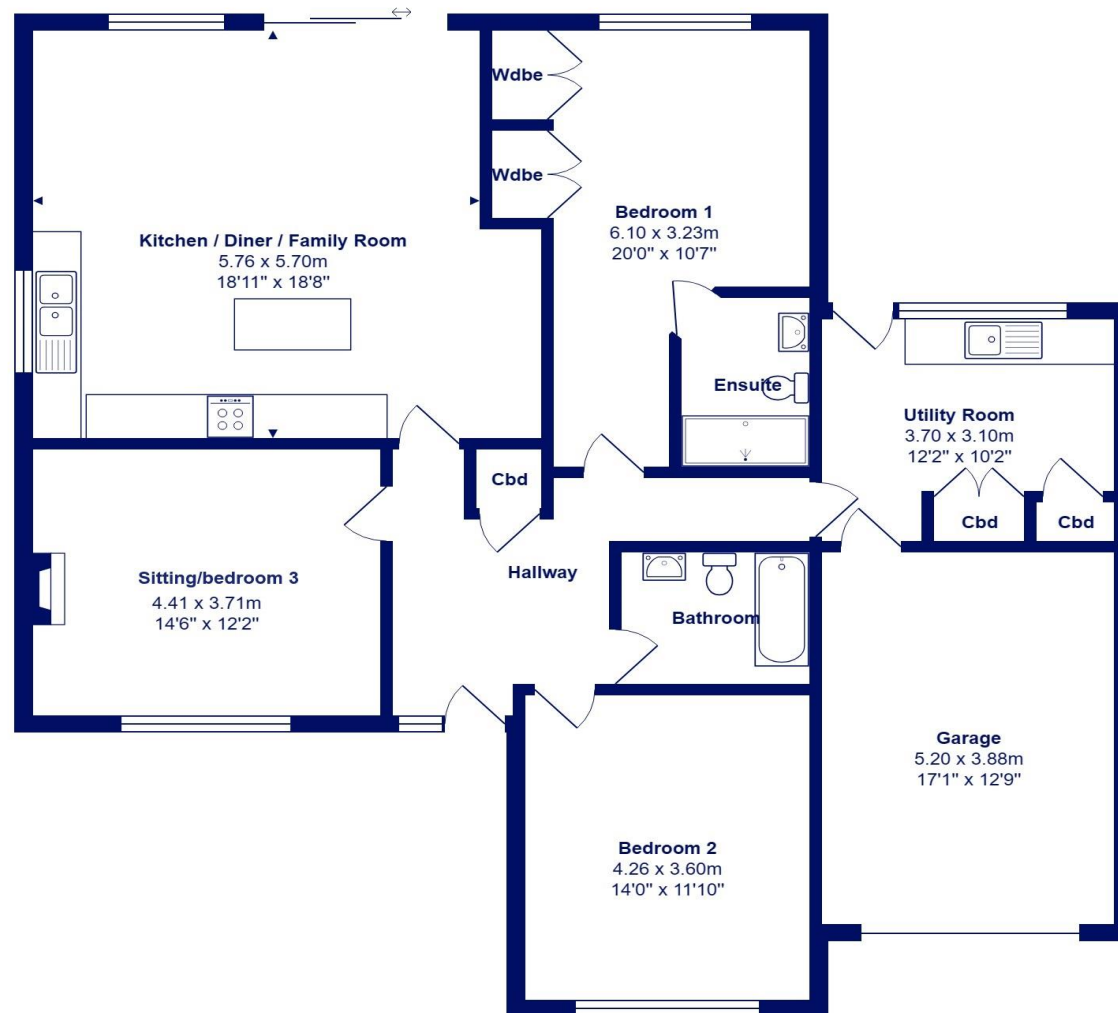

Total Area: 116.5 m² ... 1254 ft² (excluding garage)

All measurements are approximate and for display purposes only





284 Lymington Road, Highcliffe on Sea, Christchurch, Dorset BH23 5ET highcliffe@mitchells-estateagents.co.uk

01425 272206
mitchells.uk.com