



12a Woodfield Gardens, Highcliffe on Sea, BH23 4QA

£485,000

Mitchells
1963 — TODAY



12a Woodfield Gardens, Highcliffe on Sea

A stunning and recently built detached bungalow of about 800sqft with a crisp contemporary finish, the balance of a new home warranty and a beautifully laid out garden. The bungalow is extremely light and airy with high quality fittings and is presented in show home order throughout. The bungalow is situated on a corner plot with off road parking to the front and it enjoys a pretty outlook to the front over a large, grassed area, whilst the space at Wingfields and the shops at Saulflands are nearby.

- TWO BEDROOMS • BATHROOM • KITCHEN • LOUNGE/DINER • GARDENS • OFF-ROAD PARKING

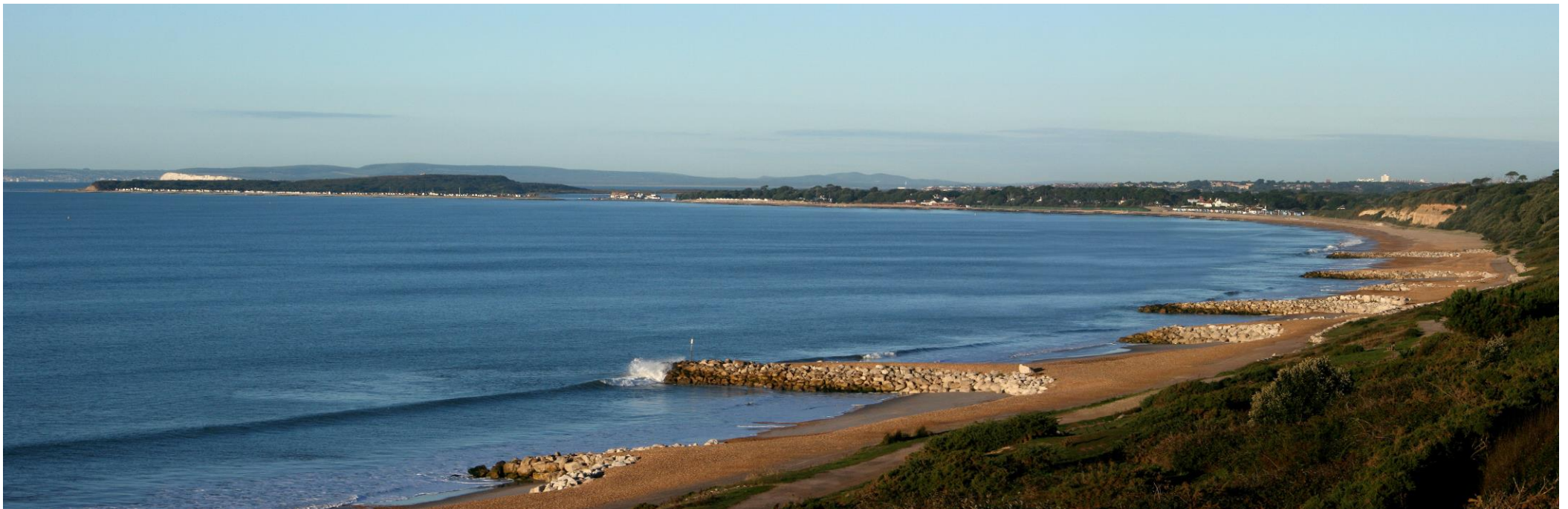

The Property

- Stylish detached bungalow built in 2018
- Immaculate inside and out with attractively clad external elevations
- Double aspect sitting/dining room with French doors onto the garden
- Two spacious double bedrooms with fitted wardrobes
- Very smart bathroom with designer fittings and ceramic tiling
- Top quality fitted kitchen with integrated appliances and double doors to the sitting/dining room
- Delightful garden with large patio, colourful flower and shrub borders and a high degree of privacy, garden chalet
- Gas fired heating and anthracite UPVC double glazed windows
- Council Tax 'D'
- EPC 'B'



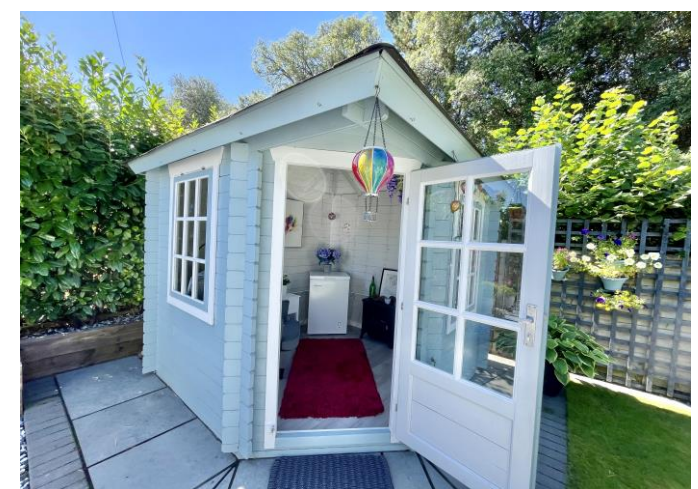

Location

Highcliffe is a small village in the borough of Christchurch, Dorset. The village lies on a picturesque stretch of Solent coastline with views over Christchurch Bay to the Isle of Wight. Fuelled by its enviable location, coastal walks, main line railway links to London (in under two hours) excellent schools and the popularity of the Chewton Glen Hotel, the Highcliffe Golf Course and the Nature Reserve at Steamer Point, Highcliffe is a popular area for those relocating to the coast.

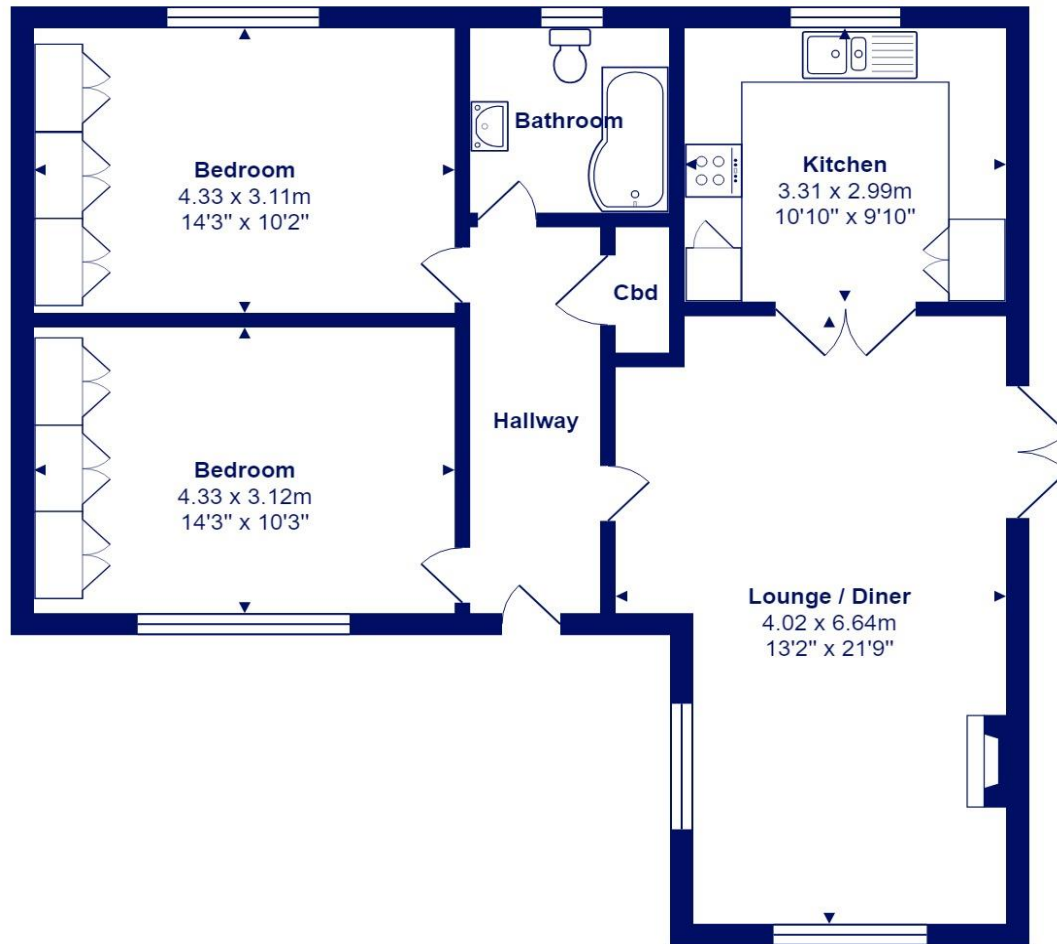

Total Area: 74.9 m² ... 806 ft²

All measurements are approximate and for display purposes only







mitchells.uk.com
highcliffe@mitchells.uk.com
01425 272206

Highcliffe
284 Lymington Road
Highcliffe
BH23 5ET

