



4 White Knights, Barton on Sea, BH25 7HA

£445,000

Mitchells
1963 — TODAY



*4 White Knights
Barton on Sea
New Milton
Hampshire
BH25 7HA*

A beautifully presented three bedroom semi detached house situated in a lovely peaceful position within easy walking distance of Barton On Sea's clifftop and beach. The property has been comprehensively modernised throughout and other features include a good sized and well landscaped south facing rear garden, a large master bedroom, a modern kitchen and bathroom, excellent decorative order throughout, a garage and off road parking.

- Entrance Hall
- Sitting/Dining Room
- Kitchen
- Cloakroom
- Landing
- Three Bedrooms
- Bathroom
- Off Road Parking
- Garage
- Private Gardens



The Property

Entrance hall with tiled flooring, a double glazed front door and stairs to the first floor.

Superb large kitchen/dining room with large understairs storage, feature contemporary fire with stone backing, Gazco living flame gas fire, large picture window overlooking the garden, UPVC double glazed casement door onto the patio and a superb south facing outlook.

Modern kitchen fitted with a large range of grey wall and base units with a contrasting timber effect worktop and an inset sink unit with mixer tap over, integrated double electric oven, four burner gas hob and extractor, integrated washing machine, part tiled walls, space for tall fridge freezer, recess ceiling spotlights, tiled flooring, UPVC double glazed door to outside and an outlook to the front.

Ground floor cloakroom fitted with a modern white suite comprising a WC, hand basin with storage beneath and tiled flooring.

First floor landing with trap to the roof space and airing cupboard housing the modern wall mounted Worcester gas fired boiler installed in November 2022.

Three bedrooms, including a superb large master bedroom with built in wardrobes and a southerly aspect.

Fully tiled bathroom fitted with a modern white suite comprising a tiled panel bath with an independent shower over, wash basin with storage beneath, WC, tiled flooring, ladder style heated towel rail and an extractor fan.





Gardens & Grounds

The front garden is laid mainly to well kept lawn for ease of maintenance with textured paved pathways and a tarmac driveway providing off road parking and leading to the single garage with up and over door, power and light.

Side lobby provides access to both the front and rear garden.

The rear garden is a particular feature of the property having a textured paved patio adjoining the rear with the remainder laid mainly to well kept lawn with colourful and well stocked beds and borders, enjoying a good degree of privacy and a sunny southerly aspect. There is also a remote control operated sun canopy.

Services

- Mains gas, electric, drainage and water
- Council Tax Band D
- Energy Performance Rating To be confirmed

Ground Floor

Approx. 44.4 sq. metres (477.8 sq. feet)

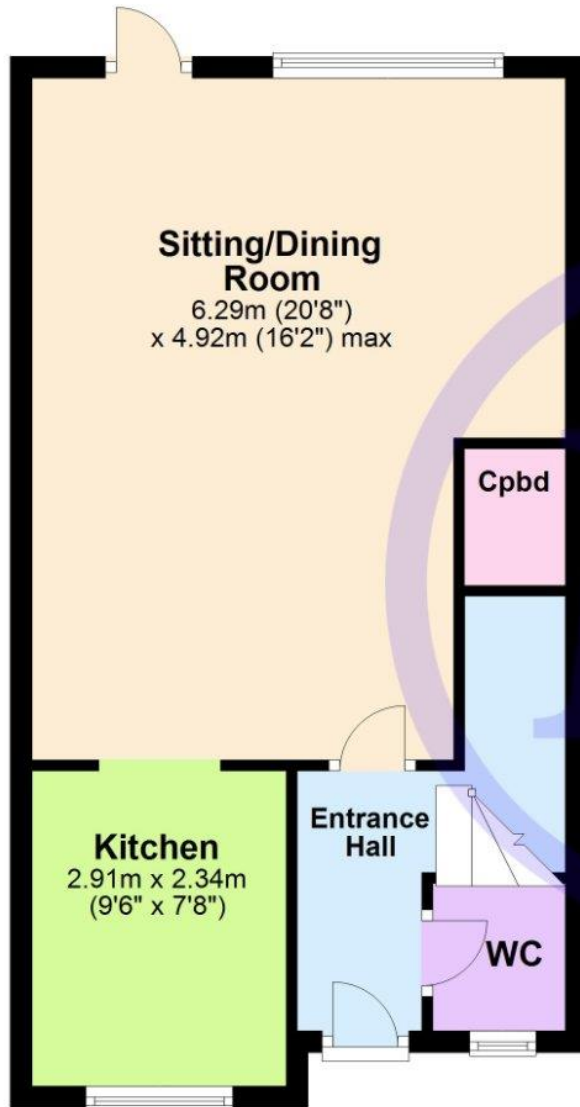

First Floor

Approx. 45.7 sq. metres (492.3 sq. feet)

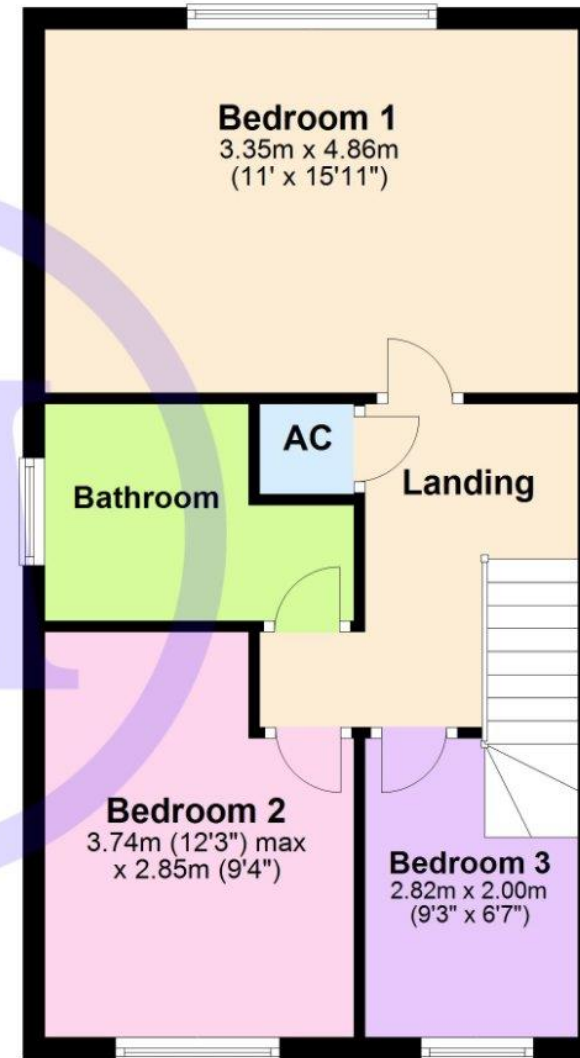

'Whilst every attempt has been made to ensure the accuracy of this floor plan, the measurements of doors, windows, rooms and any other items are approximate and no responsibility is taken for any error, omission or mis-statement. This plan is for illustrative purposes only and should be used as such by any prospective purchaser.'

Plan produced using PlanUp.

4 White Knights, Barton on Sea, New Milton

Situation

Barton on Sea is a suburb of New Milton and occupies an enviable position on a picturesque stretch of the Solent coastline with stunning views over Christchurch bay to the Isle of Wight and beautiful coastal walks in both directions. Fuelled by its excellent location, the nearby open forest of the New Forest National Park, main line rail links to London Waterloo, quality schooling, luxury restaurants including the renowned Chewton Glen hotel and Pebble Beach on the cliff top, Barton on Sea is an extremely popular choice for those relocating to the coast.

Directions

From Mitchells turn right at the traffic lights and proceed along Station Road. Take the second turning right into Barton Court Road. At the crossroads continue across into Barton Court Avenue. Take the fourth turning left into White Knights where the property will be found on the right hand side.

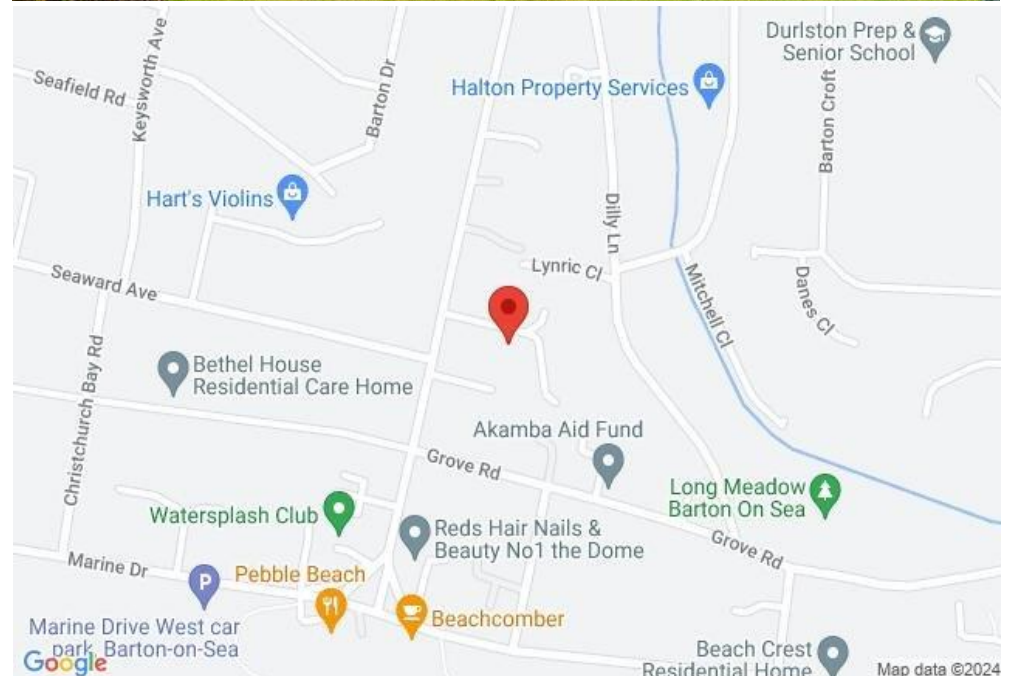



Mitchells.uk.com
info@mitchells.uk.met
01425 616411

Centenary Buildings
8-10 Old Milton Road
New Milton
Hampshire
BH25 6DT

Mitchells
1963 — TODAY

