



31 Barrs Wood Road, New Milton, BH25 5HS

£1,250,000

Mitchells
1963 — TODAY



*31 Barrs Wood Road
New Milton
Hampshire
BH25 5HS*

A stunning four/five double bedroom detached residence presented in first class order throughout situated at the head of a peaceful cul de sac in one of the areas finest roads. The property has recently been extended and comprehensively refurbished to an excellent standard of specification and offers approximately 2870sqft of accommodation. Other features of the property include a fantastic open plan kitchen/dining/living area stretching across the rear of the property with two sets of bi-fold doors onto the patio and rear garden, a separate snug lounge, an impressive reception hall, a newly constructed double carport, three bath/shower rooms, immaculate decorative order throughout, a lovely secluded plot and a huge first floor studio room currently used as a games room but could easily be utilised as a large home office, extra bedroom accommodation etc.

- Reception Hall
- Open Plan Kitchen/Dining/Living Area
- Snug Lounge
- Utility Room
- Four Ground Floor Double Bedrooms
- En-Suite Shower Room
- Family Bathroom
- En-Suite Bathroom
- First Floor Studio Room
- Office
- Garden Store
- Off-Road Parking
- Double Car Port



The Property

Impressive reception hall with engineered Oak flooring, timber staircase with recessed lighting and a storage cupboard

Superb large kitchen/dining/living area with the kitchen area having an excellent range of high quality units with soft closing drawers and doors and attractive stone effect worktops with an under mounted sink and Qooker mixer tap over, island unit with breakfast bar and seating for four, integrated Siemens electric oven, convection oven, five burner gas hob, dishwasher, full height fridge and separate freezer, attractive tiled flooring and bi-fold doors onto the rear patio

Spacious dining area with engineered Oak flooring, a contemporary radiator and with ample room for large dining table

Living area with bi-fold doors onto the rear patio, gas log effect contemporary fire, recessed ceiling spotlights, engineered Oak flooring and a lovely outlook over the rear garden

Useful separate utility room with spaces for washing machine and tumble dryer, white wall and base units with soft closing doors, timber effect worktop, sink with mixer tap over, double glazed Velux window providing an abundance of light, airing cupboard housing pressurised hot water cylinder, wall mounted Gloworm gas fired boiler concealed in cupboard, UPVC double glazed door to outside and tiled flooring

Snug lounge with engineered Oak flooring, useful storage cupboard, recessed ceiling spotlights and an outlook to the side

Four ground floor double bedrooms, two of which have built in wardrobes and two having luxury en-suites with the master bedroom benefitting from a spacious bathroom

Family bathroom fitted with a high quality white suite

Spacious first floor studio room, currently used as a games room with six double glazed Velux windows providing an abundance of light. This large room could easily be sub-divided into further bedroom accommodation, if required, and is suitable for a variety of purposes





Gardens & Grounds

The property sits on a large secluded plot accessed via electrically controlled twin timber gates. The large sweeping driveway provides excellent off-road parking and the remainder of the front garden is laid mainly to lawn and benefits from a newly constructed double car port measuring 5.91m x 5.16m with power and light.

To the side of the property is a large timber building which is currently sub-divided into a well equipped home office measuring 3.75m x 3.06m and a large secure garden store.

The rear garden is a particular feature having a large area of patio and the remainder laid mainly to lawn with well stocked borders facing a sunny south westerly direction enjoying a good degree of privacy. There is also a recently constructed bar, covered seating area, power and light.

Services

- Mains gas, electric, drainage and water
- Council Tax Band E
- Energy Performance Rating D

Ground Floor

Approx. 197.6 sq. metres (2127.1 sq. feet)

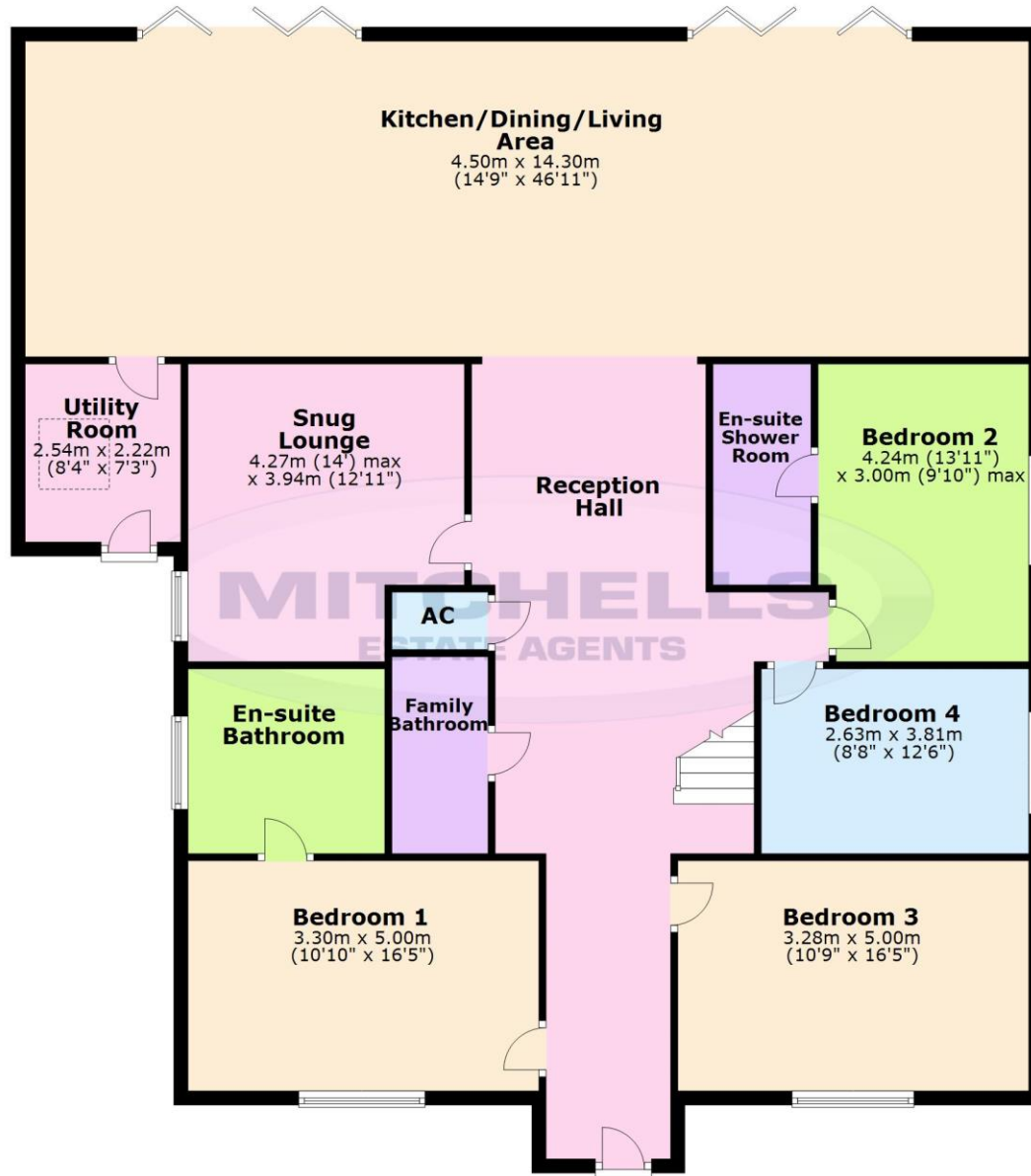

First Floor

Approx. 69.1 sq. metres (743.7 sq. feet)

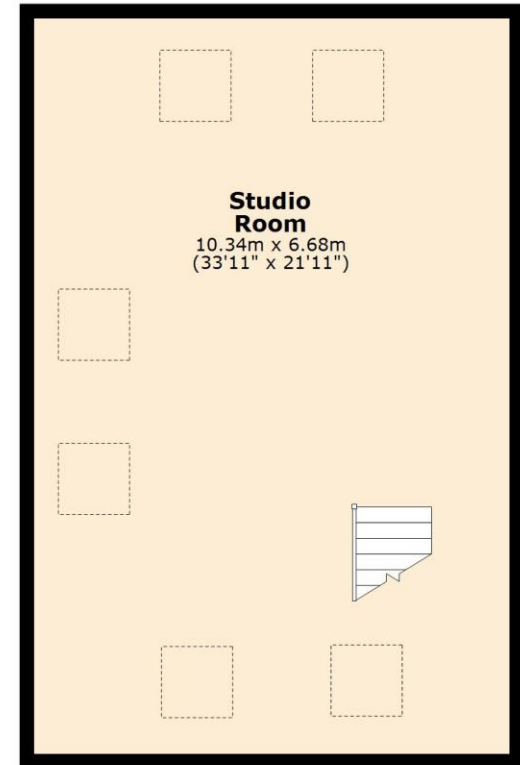

Total area: approx. 266.7 sq. metres (2870.8 sq. feet)

'Whilst every attempt has been made to ensure the accuracy of this floor plan, the measurements of doors, windows, rooms and any other items are approximate and no responsibility is taken for any error, omission or mis-statement. This plan is for illustrative purposes only and should be used as such by any prospective purchaser.'
Plan produced using PlanUp.

31 Barrs Wood Road, New Milton

Situation

New Milton is a thriving market town on the western edge of Hampshire. The area lies on a picturesque stretch of the Solent coastline with stunning views over Christchurch Bay to the Isle of Wight. With the enviable location, beautiful coastal walks, main line railway station reaching London Waterloo in less than two hours, excellent schools, both private and state, 27 hole links style golf course and the renowned Chewton Glen hotel, New Milton remains an extremely popular location for those relocating to the coast.

Directions

From Mitchells turn left at the traffic lights and proceed over the railway bridge. Take the second turning right into Brook Avenue. At the end bear left into Brook Avenue North, take the first turning right into Barrs Wood Road where the property will be found at end on the left hand side.





Mitchells.uk.com
info@mitchells.uk.met
01425 616411

Centenary Buildings
8-10 Old Milton Road
New Milton
Hampshire
BH25 6DT

Mitchells
1963 — TODAY

