



*12 Woodfield Gardens, Highcliffe on Sea, BH23 4QA      £569,950*

**Mitchells**  
1963 — TODAY





# *Woodfield Gardens, Highcliffe on Sea*

An immaculate property that had been thoroughly refurbished and extended in recent years. The detached bungalow in a smart contemporary style with accommodation approaching 1200sqft. The bungalow is situated in this popular residential area with open outlook to the front with easily maintained gardens enjoying all day sunshine and is just a short stroll to the local shops at Saulflands.

- THREE BEDROOMS • TWO BATH/SHOWER ROOMS • OPEN-PLAN KITCHEN/DINING/LIVING ROOM • SEPARATE SITTING ROOM • GARDENS • OFF-ROAD PARKING •





## The Property

- Spacious three bedroom detached bungalow
- Two smart bath/shower rooms
- Stylish open plan kitchen/dining/living room with access onto the garden
- Large second reception room perfect as a another sitting room
- A lovely sunny south facing easily maintained rear garden
- Gas fired central heating & upvc double glazing
- Off road parking for several cars
- Walking distance to Wingfields recreation ground and the local shops at Saulflands
- Hinton Admiral main line railway station is just around the corner
- Highcliffe school catchment area
- EPC 'D'
- Council Tax 'E' £2796.19







## Location

Highcliffe is a small village in the borough of Christchurch, Dorset. The village lies on a picturesque stretch of Solent coastline with views over Christchurch Bay to the Isle of Wight. Fuelled by its enviable location, coastal walks, main line railway links to London (in under two hours) excellent schools and the popularity of the Chewton Glen Hotel, the Highcliffe Golf Course and the Nature Reserve at Steamer Point, Highcliffe is a popular area for those relocating to the coast.



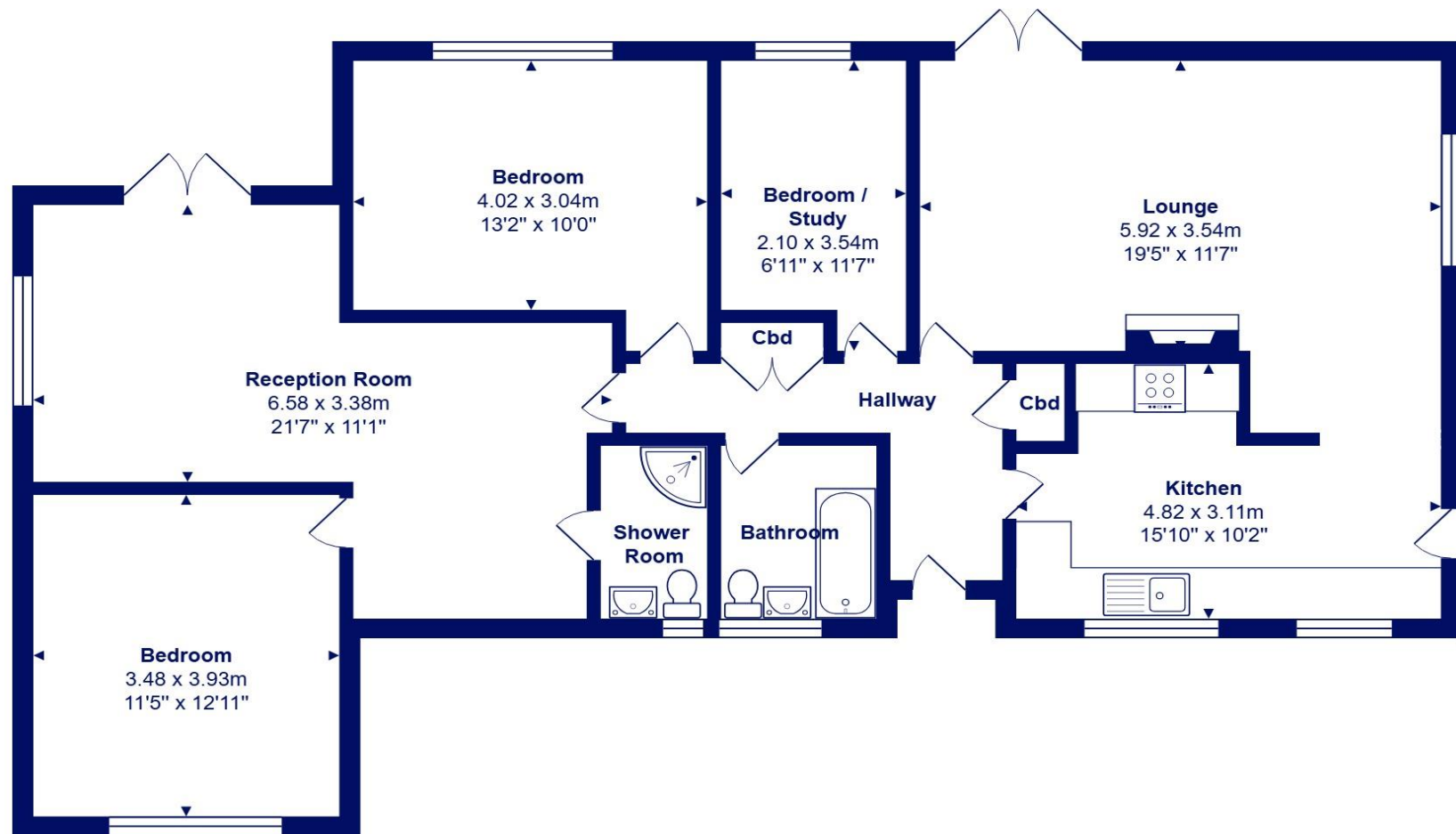

Total Area: 110.2 m<sup>2</sup> ... 1186 ft<sup>2</sup>

All measurements are approximate and for display purposes only









[mitchells.uk.com](http://mitchells.uk.com)  
[highcliffe@mitchells.uk.com](mailto:highcliffe@mitchells.uk.com)  
01425 272206

Highcliffe on Sea  
284 Lymington Road  
Highcliffe on Sea  
BH23 4TH

