



*43 Westwood Park, Bashley Cross Road, BH25 5TB*

£185,000

**Mitchells**  
1963 — TODAY





*43 Westwood Park  
Bashley Cross Road  
New Milton  
Hampshire  
BH25 5TB*

A delightful two double bedroom park home that has been refurbished to a high standard throughout and occupies an elevated prominent corner plot on the edge of one of New Milton's most popular parks with a westerly outlook over local woodland. Features of the property include a fully integral kitchen that is open planned into dining/living space, fully tiled bathroom and excellent storage throughout. Outside the property the gardens are well stocked with colourful shrubs and flowers with off road parking and good outside storage.

- Entrance Hall
- Inner Hallway
- Kitchen
- Sitting Room
- Dining Area
- Two Double Bedrooms
- Bathroom





## The Property

Steps leading to the front door on the south side of the building.

Entrance hall opens up into a spacious inner hall with built in cloaks cupboard and space for desk.

Sitting room enjoys a dual aspect on the south and west side of the building with a pleasant outlook over local woodland and door leading to the front garden. The sitting room is open planned into the dining room that intern leads to the kitchen.

Dining room with built in airing cupboard with a Worcester combination boiler.

The kitchen has been recently fitted to a high standard with matching wall and base storage cupboards, wood effect laminate flooring, matching worktops, integral items comprise of a fridge freezer, washing machine and electric oven with gas hob, space for dishwasher and a pleasant southerly outlook over the side garden.

Two double bedrooms, bedroom one of a particular generous size being the full width of the park home with custom built wardrobes and drawer units and enjoying a dual aspect on the east and south side.

Main bathroom with fully tiled walls, wood effect laminate flooring and a white suite comprising a full sized bath with shower over, wall hung wash hand basin with storage under, low flush WC, window, chrome ladder towel rail and extractor fan.

\*Newly fitted and insulated roof

\*Underneath refurbished and insulated





## *Gardens & Grounds*

The property is situated on a corner plot surrounded with colourful and mature shrubs and flowers with access to the front of the property.

To the rear of the property is a driveway with a timber gate adding privacy and security, outside storage units and stairs leading to the front door.

## *Services*

- Mains gas, electric, drainage and water

## Ground Floor

Approx. 57.3 sq. metres (616.7 sq. feet)

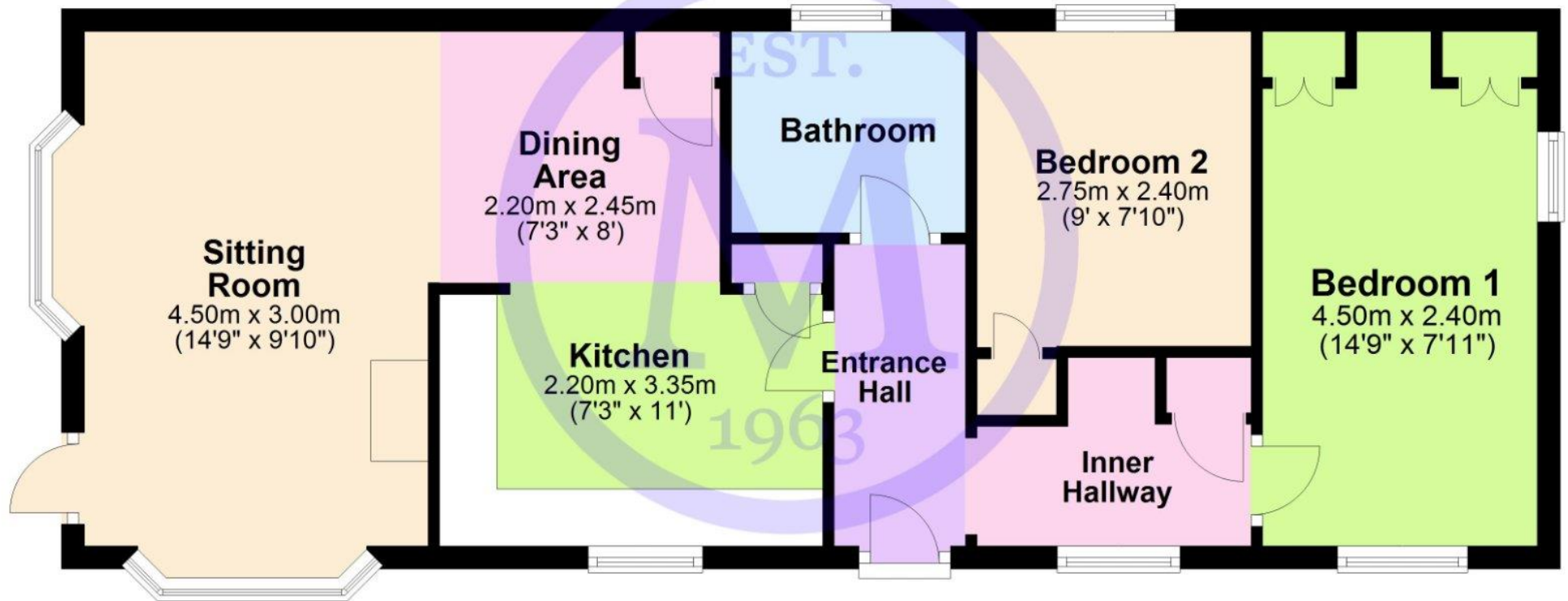

'Whilst every attempt has been made to ensure the accuracy of this floor plan, the measurements of doors, windows, rooms and any other items are approximate and no responsibility is taken for any error, omission or mis-statement. This plan is for illustrative purposes only and should be used as such by any prospective purchaser.'

Plan produced using PlanUp.

**43 Westwood Park, New Milton**



## Situation

Bashley is a small village situated within the stunning New Forest National Park with its 92,000 acres of beautiful countryside. The village has a superb convenience store/Post Office, football and cricket grounds, a country pub and two nurseries/garden centres. The town of New Milton with its mainline rail links, Barton on Sea clifftop and beach and the open forest of the New Forest National Park are all within easy reach.

## Directions

From Mitchells proceed east on Old Milton Road. Upon reaching a mini roundabout continue straight across and turn immediately right in Gore Road. After approximately one mile turn right into Stem Lane. At the T-junction turn left, take the second right into Westwood Park where the property will be seen after a short distance on the right hand side.

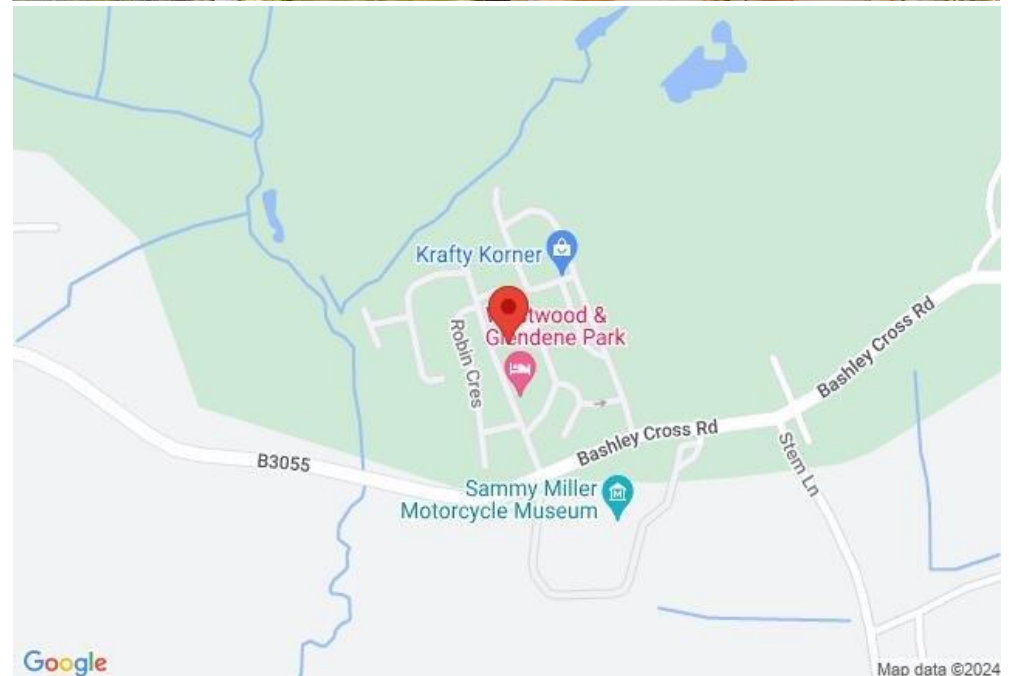





[Mitchells.uk.com](http://Mitchells.uk.com)  
[info@mitchells.uk.com](mailto:info@mitchells.uk.com)  
01425 616411

Centenary Buildings  
8-10 Old Milton Road  
New Milton  
Hampshire  
BH25 6DT

**Mitchells**  
1963 — TODAY

