



BODOWEN ROAD, BURTON, CHRISTCHURCH BH23 7JL

Mitchells
1963 — TODAY



Bodowen Road, Burton, Christchurch BH23 7JL

An immaculate and very spacious detached bungalow of some 1,100 sq ft, tucked away in this lovely location with a stunning rear garden backing onto the park. This super home is flooded with natural light and has modern fixtures and fittings throughout with excellent living space and a quality UPVC conservatory extension. Viewing highly recommended.

**THREE/FOUR BEDROOMS • TWO BATH/SOWER ROOMS (ONE EN-SUITE) • KITCHEN/ BREAKFAST ROOM
• LOUNGE • DINING ROOM/BED FOUR • SEPARATE W/C • CONSERVATORY
UTILITY/ STORE ROOM • STUNNING GARDENS
GARAGE • DRIVEWAY PARKING FOR SEVERAL CARS**



The Property

- Show home order, inside and out
- Large master bedroom with en-suite
- Two/three further bedrooms
- Comprehensively fitted kitchen/breakfast room
- Bright and airy lounge leading to UPVC conservatory
- Useful utility room and integral garage
- Gas fired central heating and UPVC double glazing
- Tasteful décor throughout
- Beautifully stocked garden with all day sunshine
- Strolling distance to the local pub and village green
- Council Tax Band 'D' - £2,165.00
- EPC rating 'D'





Location

Christchurch is a beautiful, vibrant and historic town with its 11th century priory, quay/harbour, ancient castle ruins and various shops, cafes, restaurants and bars. The Town is well served for transport links with a main line railway station to London/Waterloo being just under 2 hours and Bournemouth International Airport about 5 miles distant. Excellent infant, junior and senior schools are also within easy reach as is the stunning the New Forest National Park.

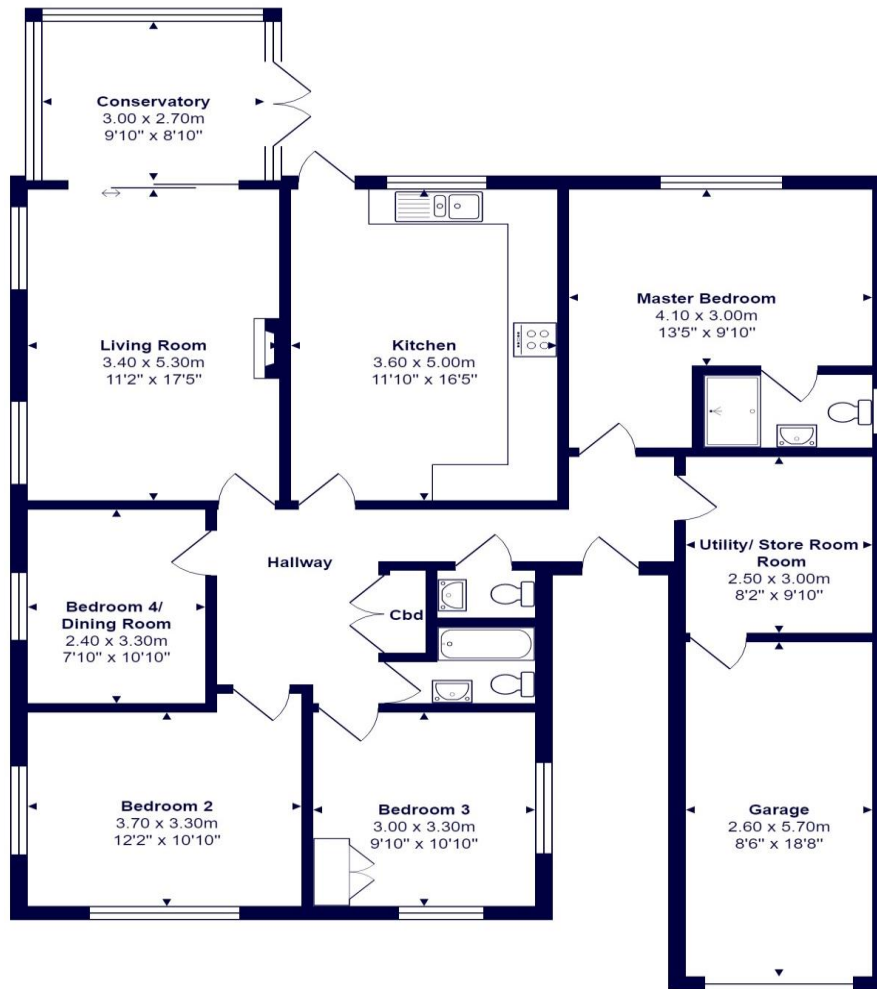

All measurements are approximate and for display purposes only





mitchells.uk.com

mudford@mitchells.uk.com

01202 499295

Mudford

Cambridge House

112-114 Stanpit

BH23 3ND

